

VEVOR[®]

TOUGH TOOLS, HALF PRICE

Technical Support and E-Warranty Certificate
www.vevor.com/support

Steel Wire Rope User Manual

Model: S1/16-328, S1/8-300, S1/16-164

We continue to be committed to provide you tools with competitive price. "Save Half", "Half Price" or any other similar expressions used by us only represents an estimate of savings you might benefit from buying certain tools with us compared to the major top brands and does not necessarily mean to cover all categories of tools offered by us. You are kindly reminded to verify carefully when you are placing an order with us if you are actually saving half in comparison with the top major brands.

VEVOR[®]

TOUGH TOOLS, HALF PRICE

Steel Wire Rope



NEED HELP? CONTACT US!

Have product questions? Need technical support? Please feel free to contact us:



CustomerService@vevor.com

This is the original instruction, please read all manual instructions carefully before operating. VEVOR reserves a clear interpretation of our user manual. The appearance of the product shall be subject to the product you received. Please forgive us that we won't inform you again if there are any technology or software updates on our product.

WARNING

1. Read carefully and understand all **ASSEMBLY AND OPERATION INSTRUCTIONS** before operating.
2. Failure to follow the safety rules and other basic safety precautions may result in serious personal injury.

GENERAL SAFETY RULES

1. The steel wire rope should be straight in use and should not be bent, compressed or knotted.
2. When metal parts and equipment with sharp edges are bound steel with wire ropes, wooden boards and thick gunny bags should be laid on them to prevent damage to the steel wire ropes.
3. Please use professional tools to cut the steel wire rope; To prevent loose end of steel wire rope, please tie down the two sides of the cut-off with iron wire, and seal and weld the end of steel wire rope after cutting.
4. Do not exceed the load of the steel wire rope.
5. The steel wire rope shall not be subjected to a sudden impact load.
6. Remove rope from a reel or coil correctly without kinking.
7. Check that you have the correct rope for the application.
8. Ensure correct location of the rope on the drum (if any)
9. Inspect the wire rope for damage, wear, corrosion or abuse at the start of each time.
10. Do not bend the wire rope repeatedly at a small radius
11. Do not use wire rope in extreme temperature to avoid shortening the service life of wire rope and reduce the bearing capacity
12. Do not use excessive wear, damage and corrosion of wire rope to avoid accidents
13. Children and minors are not allowed to use this product to avoid causing personal injury
14. The safety precautions and instructions given in this manual are unable to cover in detail all the conditions and situations that may arise.
15. The operator and/or user must use common sense and caution when operating the product especially for any matters that are not referred in the above.

SAVE THESE INSTRUCTIONS

MODEL AND PARAMETERS

Model	S1/16-328	S1/8-300	S1/16-164
Diameter	1/16inch	1/8inch	3/32inch(1/16inch)
Strand	7*7	7*7	7*7
Breaking Force	1.42KN	6.14KN	1.42KN
Length	328ft	300ft	164ft
Material	304 Stainless Steel	316 Stainless Steel	Nylon Coated 304 Stainless Steel

STRUCTURE DIAGRAM

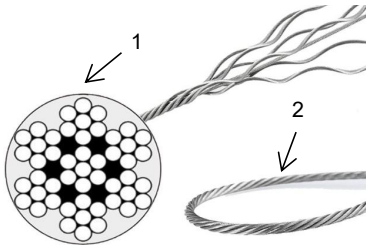

1.7*7Strand Core Cross Section 2. Steel Wire Rope(Stainless Steel)

COMPONENTS

NO.	Name	S1/16-328	S1/8-300	S1/16-164
1	Steel Wire Rope	1	1	1
2	(M2))	80	/	20
3	Thimble (M2)	20	/	20
4	Turnbuckle(M4)	/	/	4
5	Spring Snap Hook(M4)	/	/	4
6	Eye Strap	/	/	8
7	Screw(M4*30)	/	/	16
8	(M4)	/	/	16
9	Black Twist Tie	/	/	100
10	Wire Rope Cutter	/	1	/
11	User manual	1	1	1

OPERATING INSTRUCTION

1. Installation and use of components

1) Aluminum Sleeve and Thimble



2) Turnbuckle

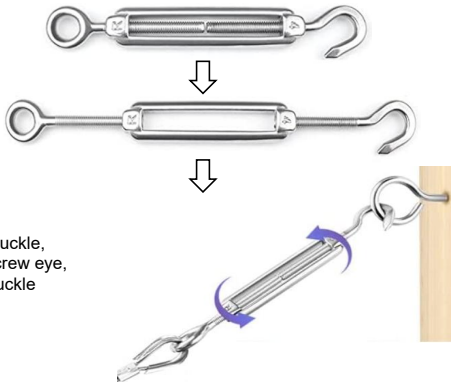

- ① Loosen the turnbuckle,
- ② hook up to the screw eye,
- ③ tighten the turnbuckle

3) Eye Strap, Plastic Anchor, Screw

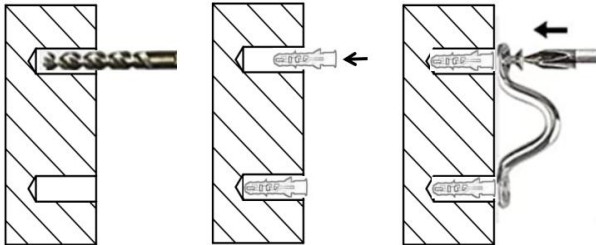

Drill

Insert plastic anchors

Screw to secure eye strap

2. Application of wire rope: (Common examples)

Use for the hanging of ornaments

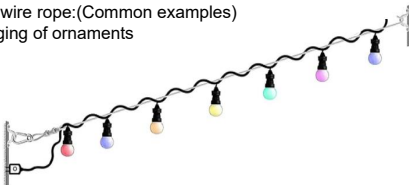

Use for hanging clothes

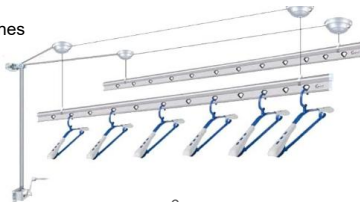

Use for Fences and guardrails

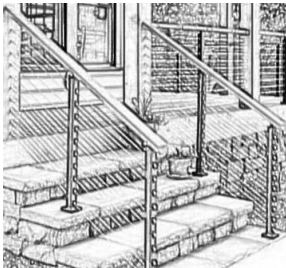

MAINTENANCE

1. After using the steel wire rope, please clean it and wrap it around the reel (if any).
2. Avoid overlapping stacking when the wire rope is stored.
3. Please store the wire rope in a dry and ventilated place.
4. The steel wire rope needs to be replaced when it is damaged seriously after long-term use.
5. If ropes are to be stored for long periods, the reel or coil should be rotated periodically, particularly in warm environments to prevent migration of the rope lubricant.
6. If the site conditions preclude inside storage the steel wire rope should be covered with a waterproof material.
7. Stainless steel wire rope also rusts in some environments, such as acid rain and humid coastal environments; it is suggested that regular cleaning and rust removal can delay the service life of the steel wire rope.

Manufacturer: Shanghaimuxinmuyeyouxiangongsi

Address: Shuangchenglu 803nong11hao1602A-1609shi, baoshanqu, shanghai 200000 CN.

EC REP: E-CrossStu GmbH.

Mainzer Landstr.69, 60329 Frankfurt am Main.

UK REP: YH CONSULTING LIMITED.

C/O YH Consulting Limited Office 147, Centurion House, London Road, Staines-upon-Thames, Surrey, TW18 4AX

Imported to AUS: SIHAO PTY LTD.

1 ROKEVA STREETEASTWOOD NSW 2122 Australia

Imported to USA: Sanven Technology Ltd.

Suite 250, 9166 Anaheim Place, Rancho Cucamonga, CA 91730

VEVOR[®]

TOUGH TOOLS, HALF PRICE

Technical Support and E-Warranty Certificate
www.vevor.com/support