

VEVOR[®]

TOUGH TOOLS, HALF PRICE

Technical Support and E-Warranty Certificate www.vevor.com/support

MICRO WOOD LATHE INSTRUCTION MANUAL

MODEL: WL1018

We continue to be committed to provide you tools with competitive price.

"Save Half", "Half Price" or any other similar expressions used by us only represents an estimate of savings you might benefit from buying certain tools with us compared to the major top brands and does not necessarily mean to cover all categories of tools offered by us. You are kindly reminded to verify carefully when you are placing an order with us if you are actually saving half in comparison with the top major brands.

VEVOR[®]

TOUGH TOOLS, HALF PRICE

MICRO WOOD LATHE

MODEL:WL1018

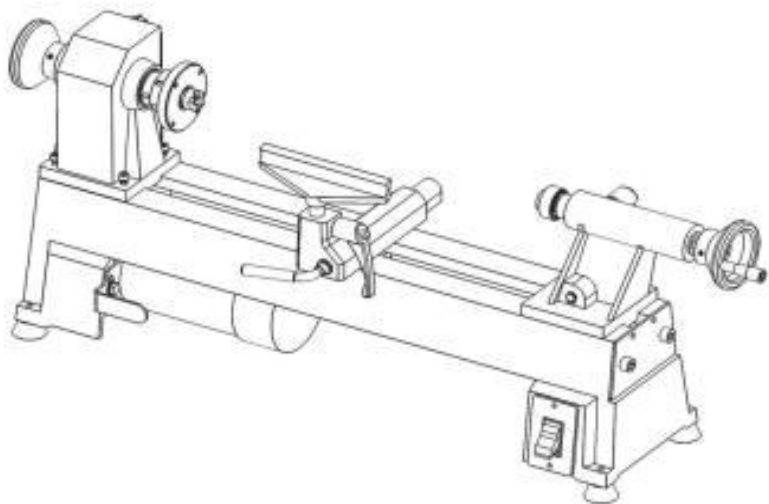

NEED HELP? CONTACT US!

Have product questions? Need technical support? Please feel free to contact us:

✉ CustomerService@vevor.com

This is the original instruction, please read all manual instructions carefully before operating. VEVOR reserves a clear interpretation of our user manual. The appearance of the product shall be subject to the product you received. Please forgive us that we won't inform you again if there are any technology or software updates on our product.

MATTERS NEEDING ATTENTION

The information contained in this handbook is intended as a guide to the operation of these machines and does not form part of any contract. The data it contains has been obtained from the machine manufacturer and from other sources. We strive to ensure the accuracy of this information and try to verify each item and each data, but we cannot guarantee the full accuracy of the information, which means that the equipment supply may differ in detail from the description of the instructions. Furthermore, development of the machine may mean that the equipment supplied may differ in detail from the descriptions herein. The responsibility therefore lies with the user to satisfy himself that the equipment or process described is suitable for the purpose intended.

QUALITY ASSURANCE



We will make every effort to ensure the quality of our products, and we promise to consumers that we will guarantee our products for one year, except for machine damage caused by improper operation of customers, and accidents resulting therefrom, or abnormal wear and damage caused by lack of maintenance.



In order to fulfill the warranty commitment, the product or part with quality problems, please return to us for verification, postage prepaid. Goods sent back should be accompanied by a note of the date of purchase and a written explanation of the quality of the product. After our inspection and confirmation, we will repair or replace their products, or refund the payment; If we fail to provide repair or replacement in a timely manner, we shall bear the costs arising from the repair or replacement of the products; If the damage is not due to the quality of the product, but due to the user's improper operation or other reasons, the cost shall be borne by the customer .

Our company reserves the right to make changes to this specification and product specifications. We will make continuous efforts to improve the quality of our products.

All rights reserved. Reproduction or reproduction is not allowed without permission.

SAFETY WARNING

Symbol	Symbol Description
	Warning - To reduce the risk of injury, user must read instructions manual carefully.
	This symbol, placed before a safety comment, indicates a kind of precaution, warning, or danger. Ignoring this warning may lead to an accident. To reduce the risk of injury, fire, or electrocution, please always follow the recommendation shown below.
	Danger! Risk of personal injury or environmental damage! Risk of electric shock! Risk of personal injury by electric shock!
	Alternating current
	Beware of clamping
	Warning- Be sure to wear ear protectors when using this product.
	Warning- Be sure to wear eye protectors when using this product.
	Warning- Be sure to wear dust masks when using this product.

	<p>This product is of protection class III.</p>
	<p>FCC statement: This device complies with Part 15 of the FCC Rules. Operation is subject to the following two conditions:(1)This device may not cause harmful interference, and (2)this device must accept any interference received, including interference that may cause undesired operation.</p>
	<p>Disposal information: This product is subject to the provision of European Directive 2012/19/EC. The symbol showing a wheeled bin crossed through indicates that the product requires separate refuse collection in the European Union. This applies to the product and all accessories marked with this symbol. Products marked as such may not be discarded with normal domestic waste, but must be taken to a collection point for recycling electrical and electronic devices</p>



WARNING: Read all safety warnings, instructions, illustrations and specifications provided with this machine. Failure to follow all instructions listed below may result in electric shock, fire and/or serious injury.

Save all warnings and instructions for future reference.

1. The machine tool should be used by experienced personnel. If you are not familiar with the operation process of the lathe, do not use the machine tool at will. Use the instructions before operating.
2. Before starting the machine tool, the safety cover should be in the correct position.
3. Before starting the machine tool, please check whether the tool rest wrench and chuck key are removed.
4. Prevent the machine from starting accidentally. Turn off the motor power before clamping the workpiece or tool.
5. Don't force cut. Cutting according to the set cutting speed, cutting depth and feed speed.
6. Use the right tools. Use the correct tool or workpiece for machining.

7. Keep the tool sharp and clean to ensure normal and safe operation. Lubricate and replace accessories regularly.
8. Before adjusting or repairing the machine, be sure to disconnect the power supply.
9. Please check the safety performance of the machine before starting it.
10. Check the performance of all moving parts. All parts must be installed
11. correctly. Damaged parts must be repaired promptly.
12. When the machine is running, the operator shall not leave.
13. Keep the working place clean, dirty working environment is easy to lead to accidents.
14. Do not use the machine in dangerous environment.
15. Do not work in damp places. Ensure that electrical components are protected from moisture. Keep good lighting.
16. Children are prohibited from entering the work site, and non-operating personnel should keep a safe distance from the work area.
17. To keep children out of the work area. The door should be locked when leaving the workshop.
18. Dress appropriately. Don't wear loose clothing, gloves, ties, rings, bracelets, jewelry, etc. To be on the safe side, For the sake of safety, wearing non-slip shoes. If you have long hair, please wear a work hat.
19. Wear protective glasses when operating.
20. Pay attention to where you stand and keep your balance at all times.
21. Do not place your hands near the moving parts of the machine.
22. Do not perform any setting operations while the machine is running.
23. Read and understand all warning signs posted on the machine.
24. This manual is intended only to familiarize customers with the operation of the machine and is not a training manual.
25. Please obey these warnings or serious injury may result.
26. The machine will produce some harmful chemicals in the work of dust, sawing, grinding and drilling produced by grinding. To reduce the harm of these chemicals, please work in a well-ventilated place and wear safety devices. Such as particulate filter masks.

TECHNICAL PARAMETER

Rating	220-240V~, 50Hz, 370W	110V~, 60Hz, 370W
Distance Between Centers	18"	
Turning diameter	10"	
Motor	370W	
Output Speed	680-3200RPM	780-3800RPM
Face Plate Diameter	80mm	
Product Dimensions	950*270*365mm	
Weight	N.W.: 31.2Kg	G.W.: 33.45Kg
Package Size	830*425*300mm	

The general information given in this specification is not binding.

Know Your Wood Lathe:

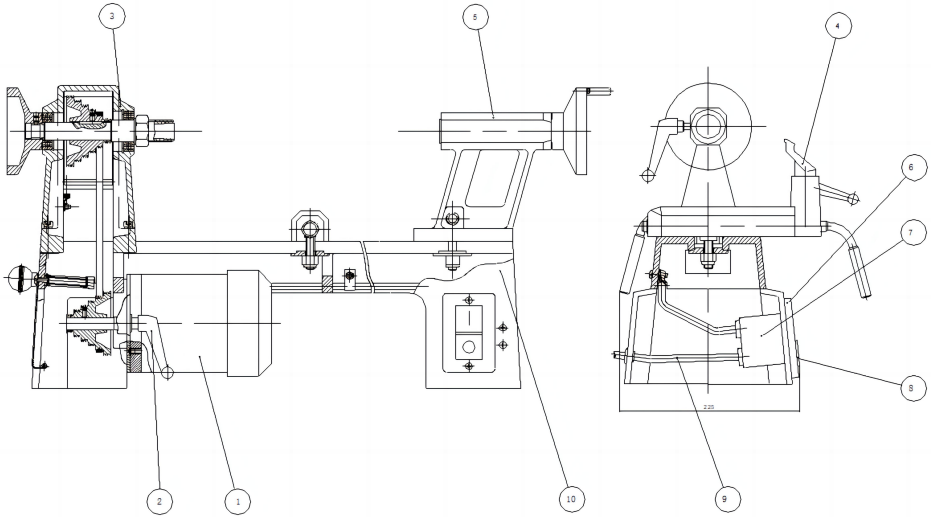

PART NO.	DESCRIPTION	QTY
1	Motor	1
2	Lock lever	1
3	Head stock	1
4	Tool rest	1
5	Tail stock	1
6	Plate	1
7	Switch box	1
8	Switch	1
9	Power cord	1
10	Bed	1

Standard accessories

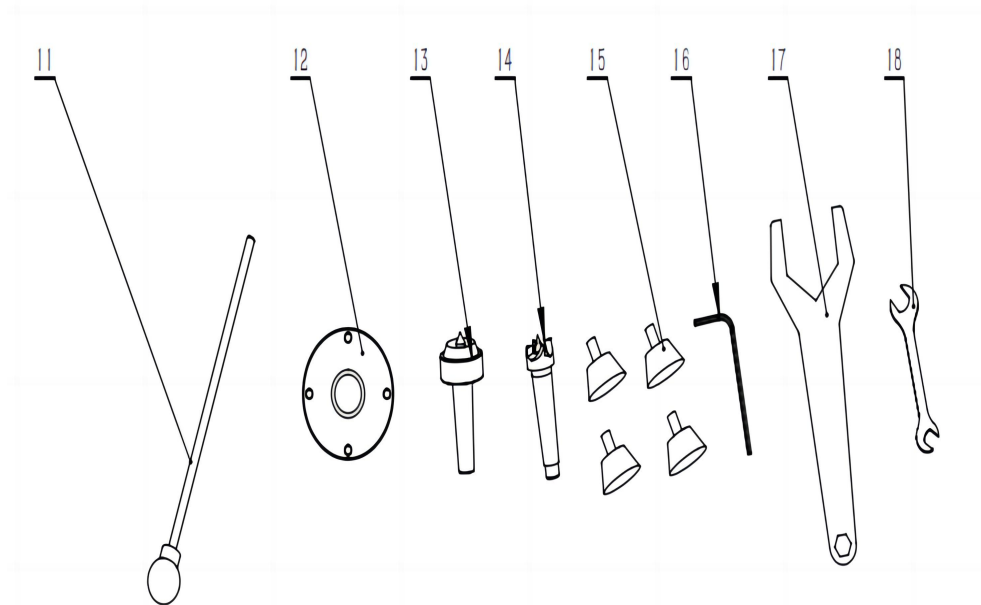

PART NO.	DESCRIPTION	QTY
11	Rod injection	1
12	Face plate	1
13	Living center	1
14	Spur center	1
15	Rubber washer	4
16	Hex wrench S3	1
17	Wrench	1
18	Fork wrench 10-13	1

UNPACKING AND CLEANING

1. Remove the woodworking lathe from the box
2. Check all the accessories of the machine tool according to the packing list.
3. Choose a location for the lathe that is dry, has good lighting and has enough room to be able to service the lathe on all four sides.
4. To avoid twisting the bed, the lathe's location must be absolutely flat and level. Bolt the lathe to the stand (if used).
5. Clean all rust protected surfaces using a mild commercial solvent, kerosene or diesel fuel. Do not use paint thinner, gasoline or lacquer thinner. These will damage painted surfaces. Cover all cleaned surfaces with a light film of 20W machine oil.

GENERAL DESCRIPTION

ADJUSTING THE MAIN SPINDLE'S SPEED

According to the work piece's requirement, you can easily adjust the main spindle's speeds.

- 1) First open the back lid (20#)of headstock(19#).
- 2) Loosen the socket head bolt (33#),
- 3) take out the motor plate (31#),
- 4) then change the speed by moving the drive belt (26#).
- 5) When finishing changing, fix the socket head bolt (33#)to motor plate(31#)and tighten them,
- 6) Fix the back lid (20#)to the head stock(19#) with the four Semicircle head screws (21#)and washer ($\phi 5$).

OPERATION

1. Before cutting the square wood, first find out the center of the square wood, and then set the wood at the center of the wood.



2. When cutting hard wood, use a wooden hammer to knock the block to the top, not using a hammer, to prevent damage to the wood.
3. Be sure to be safe when cutting square wood.
4. Pay attention to the top of the tail seat to lubricate to prevent stuck, many people usually do not pay attention to the lubrication of the machine.
5. Adjust the position of the rear seat, put the wood between the two tops, then lock the top sleeve, and start the wood.
6. Turn the tail seat hand wheel and tighten the top of the wood to two top into the wood, making the wood and become one with the top. If it's hard wood, first make a small hole in the middle of the wood, and then put the top of the wood between the two tops.



7. The height of the knife frame is 3mm higher than the center line of the main shaft and the tail seat. The height of the knife frame varies with the diameter of the cutting wood. Generally speaking, the larger the diameter of the wood, the higher the height of the knife, the smaller the diameter of the wood and the lower the height of the knife frame.



8. The turning tool should be sharpened often to ensure that it is always sharp.
9. When using the woodworking lathe for the first time, the operator should stand away from the nose position, and when the speed, change, also away from the nose position.
10. When cutting wood, the cutting knife should be placed on the cutting holder.

11. When adjusting the position of the knife holder, the power has to be turned off first, and when the operator leaves the machine.
12. When cutting wood, when the top of the spindle is found loose, you should immediately turn off the power, readjust the tail seat hand wheel, tighten the wood, and then start working.
13. Do not always move the holder position until the is done.
14. When cutting the disc and bowl, the wood is installed vertically on the plate and fixed with wooden screws. Before cutting, to ensure that the plate is firmly fixed on the spindle. When the turning tomorrow is relatively large, the speed of the spindle should first choose low speed, block the cutting bowl, disc, not the tail seat removed, you can have more space to operate.

LUBRICATION

! CAUTION

**Lathe must be serviced at all lubrication points
and all reservoirs filled to operating level before
the lathe is placed into service!
Failure to comply may cause serious damage!**

Electricity

WARNING!

Connection of the lathe and all other electrical work may only be carried out by an authorized electrician!

Failure to comply may cause serious injury and damage to the machinery and property!

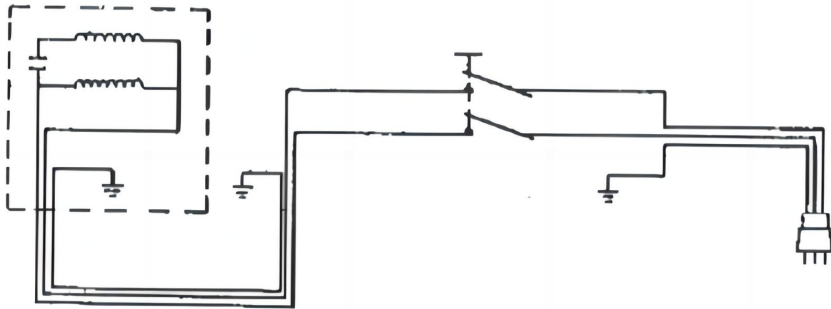

In the event of a malfunction or breakdown, grounding provides the path of least resistance for electric current to reduce the risk of electric shock. This tool is equipped with an electric cord that has an equipment grounding conductor and a grounding plug.

The plug must be plugged into a matching outlet that is properly installed and grounded in accordance with all local codes and ordinances.

Do not modify the plug provided. If it will not fit in the outlet, have the proper outlet installed by a qualified electrician.

Improper connection of the equipment grounding conductor can result in risk of electric shock. The conductor with the green insulation (with or without yellow stripes) is the equipment grounding conductor.

If repair or replacement of the electric cord or plug is necessary. Do not

connect the equipment grounding conductor to a live terminal. Check with a qualified electrician or service person if you do not completely understand the grounding instructions, or if you are not sure the tool is properly grounded.

Use only three wire extension cords that have 3-prong grounding type plugs and 3-hole receptacles that accept the tool's plug as shown in Fig.A. Repair or replace damaged or worn cord immediately.

CAUTION:IN ALL CASES,MAKE CERTAIN THE RECEPTACLE IN QUESTIONISPROPERLY GROUNDED.IF YOU ARENOT SURE,HAVE A CERTIFIED ELECTRICIAN CHECK THE RECEPTACLE.

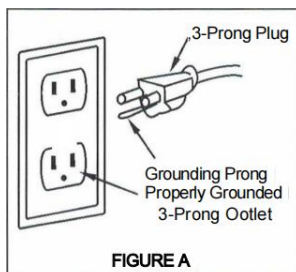

The WL1018 WOOD LATHE is rated at 220-240V~, 50Hz, 370W/110V~, 60Hz, 370W. Confirm power available at the lathe' s location is the same rating as the lathe. Make sure the lathe is properly grounded.

MAINTENANCE

Keep the maintenance of the machine tool during the operation to guarantee the accuracy and service life of the machine tool.

1. In order to retain the machine's precision and functionality, it is essential to treat it with care. Keep it clean and grease and lubricate it regularly. Only through good care, you can be sure that the working quality of the machine will remain constant.

NOTES: Disconnect the machine plug from the mains supply whenever you carry out cleaning, maintenance or repair work!

Oil, grease and cleaning agents are pollutants and must not be disposed of through the drains or in normal refuse. Dispose of those agents in accordance with current legal requirements on the environment. Cleaning rags impregnated with oil, grease and cleaning agents are easily inflammable. Collect cleaning rags or cleaning wool in a suitable closed vessel and dispose of them in an environmentally sound way - do not put them with normal refuse!

2. Lubrication all slide ways lightly before every use.
3. During the operation, the chips which fall onto the sliding surface should be cleaned timely, and the inspection should be often made to prevent chips from falling into the position between the machine tool saddle and lathe bed guide way. Asphalt felt should be cleaned at certain time.
4. After the operation every day, eliminate all the chips and clean different parts of the machine tool and apply machine tool oil to prevent rusting.
5. In order to maintain the machining accuracy, take care of the center. The surface of the machine tool for the chuck and the guide way and avoid mechanical damage and the wear due to improper guide.
6. If the damage is found, the maintenance should be done immediately.

NOTES: Repair work may only be carried out by qualified personnel with the corresponding mechanical and electrical knowledge.

EBREAKDOWN DIAGRAM AND PARTS LIST

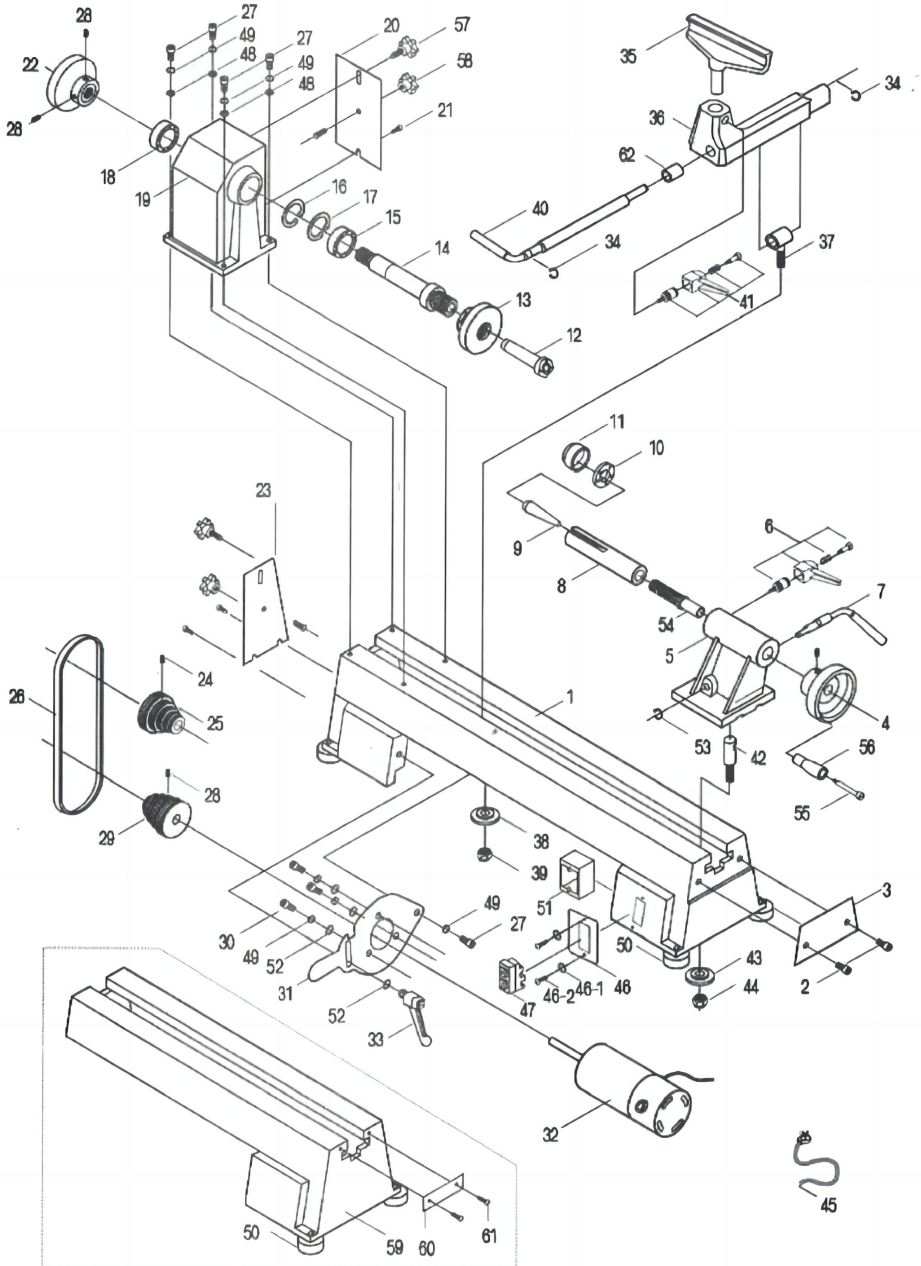

PART NO.	DESCRIPTION	QTY
1	Bed	1
2	Semicircle head screw	2
3	Retaining plate	1
4	Handwheel	1
5	Tailstock	1
6	Lock lever	1
7	Eccentric axis	1
8	Tail axis	1
9	Taper rod	1
10	Bearing ball	1
11	Cup center	1
12	Headstock spur center	1
13	Faceplate	1
14	Headstock spindle	1
15	Bearing ball	1
16	Ring retaining	1
17	Ring retaining	1
18	Bearing ball	1
19	Headstock	1
20	Back lid	1
21	Screw	3
22	Balance wheel	1
23	Side plate	1
24	Hex. socket set screw	1
25	Drive pulley	1
26	Drive belt	1
27	Hex. socket head screw M8×25	5
28	Hex. socket set screw M6×10	1
29	Motor pulley	1
30	Hex. socket head screw	3
31	Motor plate	1
32	Motor	1

PART NO.	DESCRIPTION	QTY
33	Lock lever	1
34	Ring retaining 12	2
35	Tool rest (150mm,300mm)	1
36	Tool rest base	1
37	Bolt	1
38	Lock plate	1
39	Hex. nut	1
40	Lock handle for knife base	1
41	Lock lever	1
42	Bolt	1
43	Lock plate	1
44	Hex. nut	1
45	Power cord	1
46	Plate	1
46-1	Washer	2
46-2	Screw	2
47	Switch	1
48	Washer	4
49	Spring washer	8
50	Rubber washer	4
51	Switch box	1
52	Washer	4
53	Ring retaining 10	1
54	Tailstock quill	1
55	Bolt	1
56	Handle	1
57	Moving knob	2
58	Stationary knob	2
59	Extension bed	1
60	Plate	1
61	Screw	2
62	Cover	1

VEVOR[®]

TOUGH TOOLS, HALF PRICE

Technical Support and E-Warranty Certificate

www.vevor.com/support