

Operating Instructions and Parts Manual

Please read and save these instructions. Read through this owner's manual carefully before using product. Protect yourself and others by observing all safety information, warnings, and cautions. Failure to comply with instructions could result in personal injury and/or damage to product or property. Please retain instructions for future reference.

Description

Designed to support pipes for a variety of uses. Do not exceed the maximum capacity of the product.

Inspection/Maintenance

Carefully inspect the stand prior to each use for proper assembly (such as the hand screw), wear, damage, or other issues that may affect safe usage. If any problems are found, discontinue use until the stand is repaired. Keep the stand clean and all moving parts lightly lubricated to aid in operation.

Operating Instructions and Parts Manual

General Safety Information

WARNING Read the warnings and instructions for all equipment being used before operating this tool to reduce the risk of serious personal injury.

WARNING Failure to properly support the pipe may result in tipping of the stand, dropping of the pipe, or serious injuries.

WARNING Use the appropriate safety equipment for the intended job such as eye protection, hearing protection, feet protection, dusk masks, face shields, etc to reduce the risk of injuries.

Installation and Operation

1. Make sure that all equipment is inspected and set up accordingly.
2. Make sure that the ground below the pipe stand is clear, stable, and level.
3. The legs of the pipe stand should be fully open and the feet placed squarely on the floor.
4. If the stand is equipped with rollers, ensure the rollers are properly adjusted for the pipe size

5. Fasteners on the pipe stand should be evaluated and ensure that they are secured

6. To adjust the height, grip head assembly, loosen the hand screw, and raise the lock ring to disengage the elevator tube. Move the head assembly to the desired height. Next, lower the lock ring until it engages the elevator tube, and securely tighten the hand screw. Do not raise the elevator tube past the hand screw or past the unit specifications. The jack screw can be used for fine adjustments to height. Do so by holding the head of the assembly station and carefully turning the jack screw handle to the desired height. Do not force the jack screw handle, as it may cause the screw to come loose from the stand.

7. Position the stand(s) to properly support the pipe. The pipe should be supported in at least two places at all times. The number and placement of stands depends on the size, length, and weight of the pipe length.

8. Carefully place the pipe on the stands. Make sure the pipe is properly centered on the stands to reduce the risk of tipping. Always stay clear of the supported load.

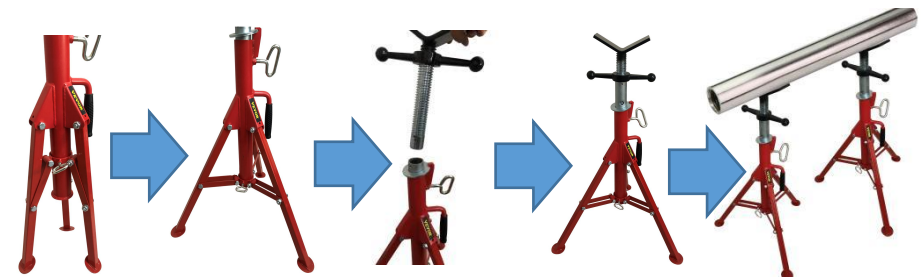

Attention:

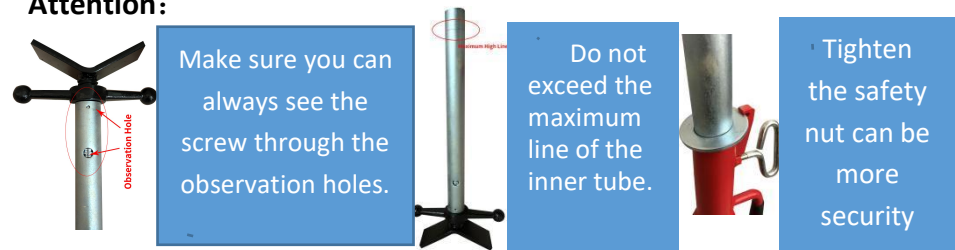



Pipe Jack Stand With V-Head
1107



Pipe Jack Stand With V-Head
1107B



Pipe Jack Stand With V-Head
1107C



Pipe Jack Stand With V-Head
1107S



Pipe Jack Stand With Roller-Head
1109



V-Head Pipe Jack Stand With 2-Ball
1107C4-BALL



V-Roller Head Pipe Stand
1106



Mul-Function Jaw Stand
1108



V-Head Pipe Jack Stand with Casters
1107AV



V-Head Pipe Jack Stand with Casters
1107BV



V-Head Pipe Jack Stand with Casters
1107CV



V-Head Pipe Jack Stand With 4-Ball
1107B4-BALL



V-Head Pipe Jack Stand With 2-Ball
1107C2-BALL



V-Head Pipe Jack Stand With 2-Ball
1107S2-BALL



V-Head Pipe Jack Stand With 4-Ball
1107S4-BALL



V-Head Pipe Jack Stand With 2-Ball
1107A2-BALL



V-Head Pipe Jack Stand With 4-Ball
1107A4-BALL



V-Head Pipe Jack Stand With 2-Ball
1107B2-BALL

Part Number	Pipe Capacity(In.)	Max Weight Capacity	Overall Height (In.)
1107	1/8 To 12	2500 lbs	28" To 52"
1107A2-BALL	1/8 To 12	1300lbs	28" To 52"
1107A4-BALL	1/8 To 12	1500lbs	28" To 52"
1107B	1/8 To 12	2500lbs	24" To 42"
1107B2-BALL	1/8 To 12	1300lbs	24" To 42"
1107B4-BALL	1/8 To 12	1500lbs	24" To 42"
1107C	1/8 To 12	2500lbs	20" To 37"
1107C2-BALL	1/8 To 12	1300lbs	20" To 37"
1107C4-BALL	1/8 To 12	1500lbs	20" To 37"
1107S	1/8 To 12	2500lbs	28" To 52"
1107S2-BALL	1/8 To 12	1300lbs	28" To 52"
1107S4-BALL	1/8 To 12	1500lbs	28" To 52"
1109	1/8 To 12	2500lbs	32" To 55"
1106	1/8 To 24	3000lbs	28" To 52"
1108		300lbs	32" To 45"