

Model E/E1 Transom launching wheel installation and operation instruction:

Tools preparedness:Ruler,Pencil,Electric portable drill,Drill bit(E:Φ 8.5mm,E1: Φ 6.5mm) , sealing gum, stay wrech (E:13#,E1:10) and Adjustable wrench(2 pcs, or Parallel-jaw vice), rags,Lubricating oil or Lithium-base grease, etc.

Step 1: Elevating the boat transom,Put the transom launching wheel close to the transom, adjust the distance(up, down, left and right) and make sure to place it in a suitable location for installation, Drawing a horizontal line to ensure the balance of the two transom launching wheels after installation, the dimensions in the figure are only for reference.

Step 2: Put the pedestal close to the horizontal line(had been drawn at step 1)Adjust the distance for pedestal(left and right), Mark location of each hole with a marker or mark location of each hole by drawing way with compasses and ruler, then vertical drilling holes with electric portable drill, drill bit diameter is about 8.5mm, drilling speed should be slow to prevent damage the transom.

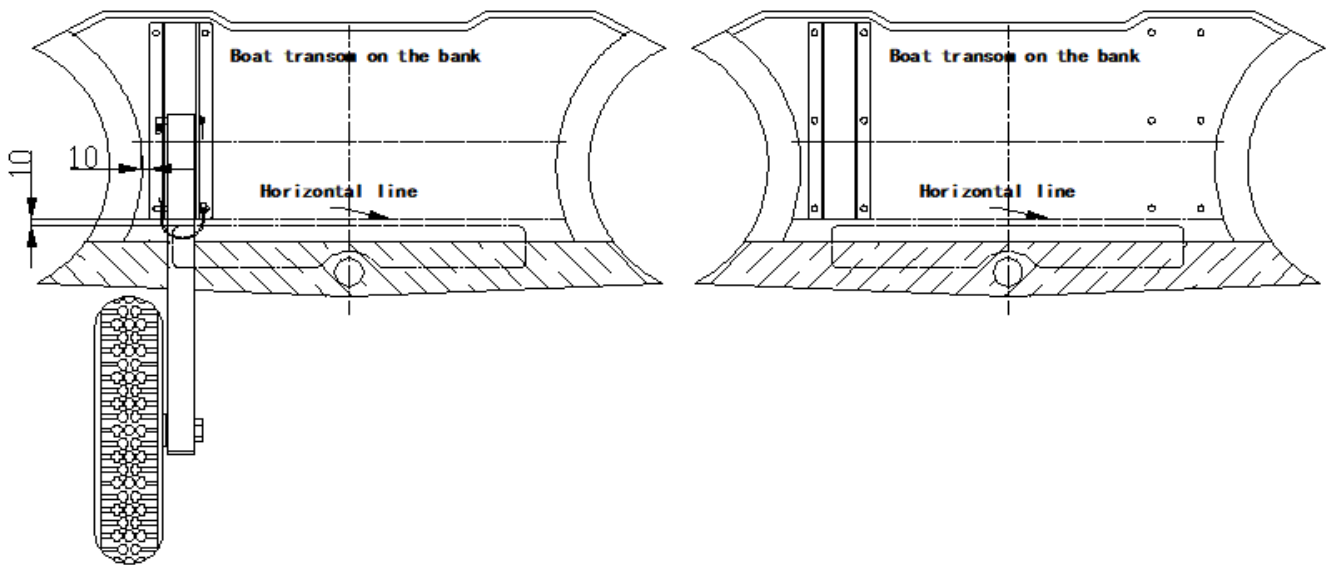

Step 3: Installing the pedestal on the transom tighten with screws.

Note:1. Preventing water enter the transom, should use the sealing gum on both screws and holes; 2. when fixing the pedestal, the stainless steel gaskets are placed inner side of the transom.

Step 4:Installing brackets and wheels on the completed placing pedestals with pin key,Turn the bracket and the wheel up and down to check the wheel is fitting well or not. In order to insure the wheels turn flexibly, please put Lithium-base grease or Lubricating oil inside of the bearing hole before use them.

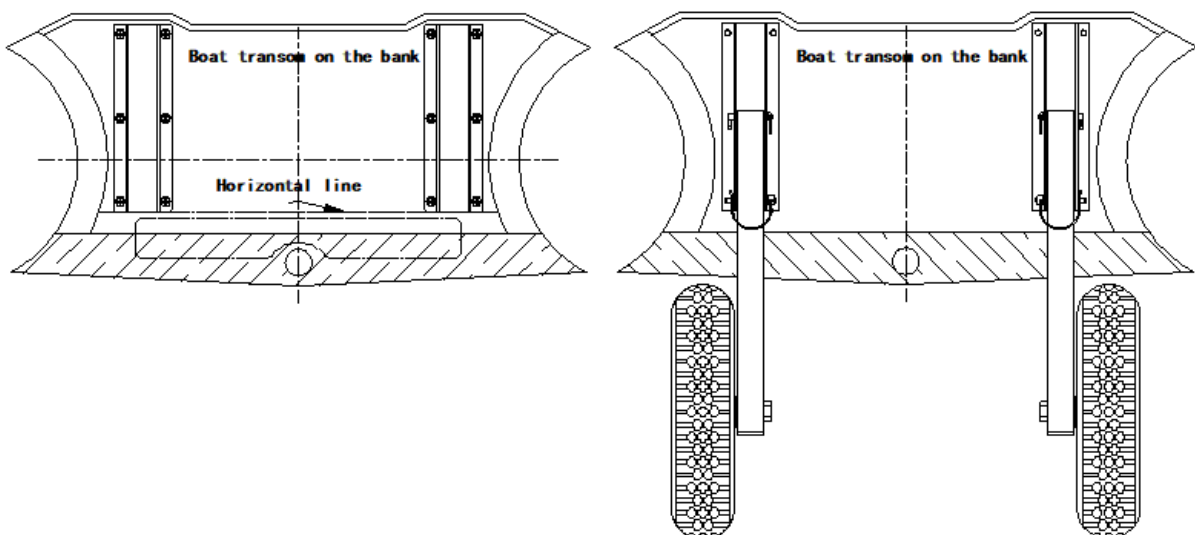

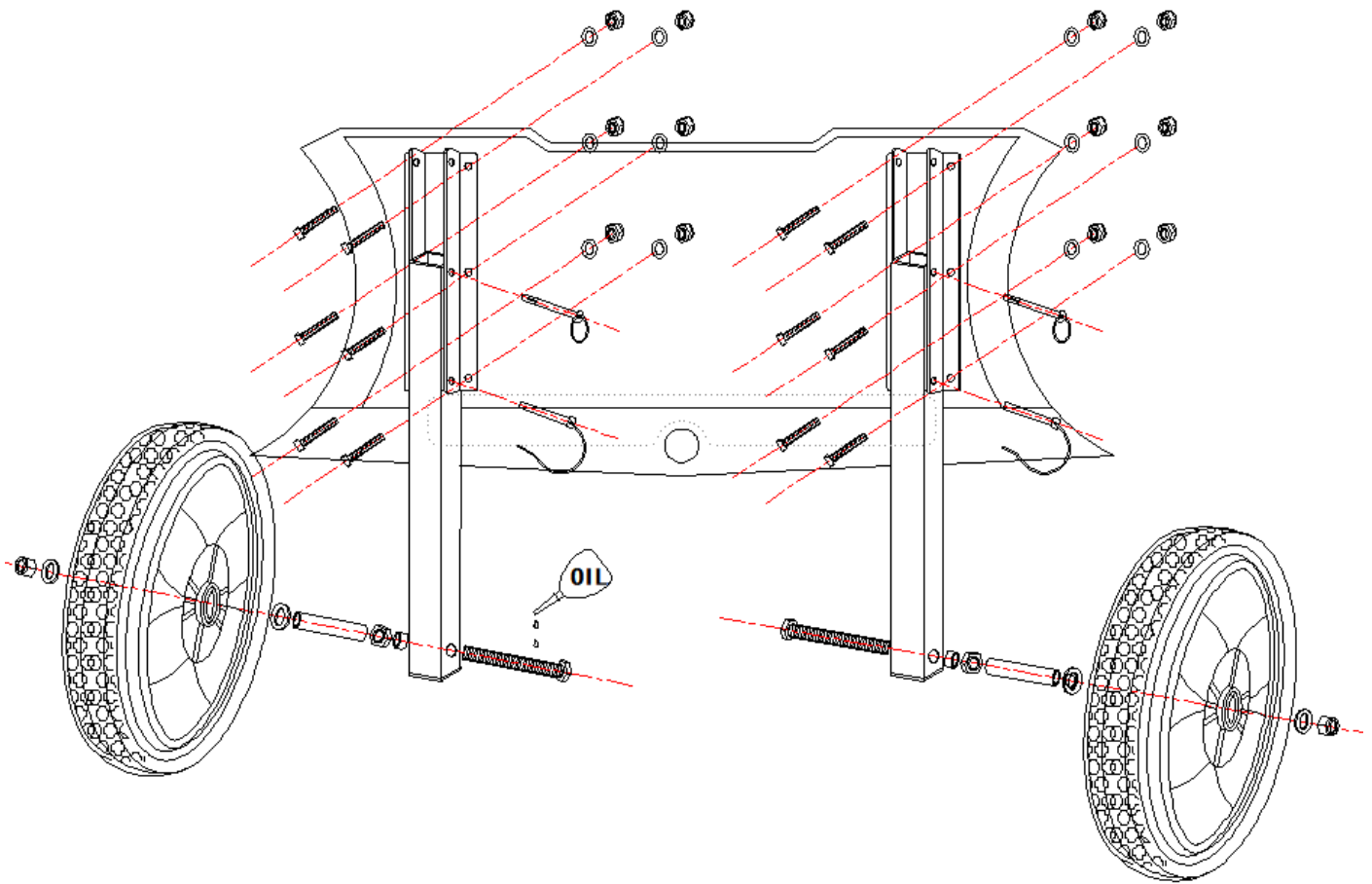

Notes for Model E/E1 Transom launching wheel installation and operation:

1. Model E Transom launching wheel are made of 304 L stainless square tubes (Specification:38*25mm),the pedestals are made of 304 L stainless plate (thickness:3mm),the screws and so on,are all using 304 L stainless steel material,the stainless steel material need to regular maintenance,Rinsing them with fresh water after using and apply anti-rust Lubricating oil ,etc.
2. Model E1 Transom launching wheel are made of Aluminum alloy steel square tubes (Specification:38*25mm),the pedestals are made of Aluminum alloy steel plate (thickness:3-4mm),Warm water containing lubricant or neutral cleaning agent shall be used for aluminum alloy maintenance, and acidic or alkaline cleaning agent is not allowed,the screws and so on,are all using 304 L stainless steel material,the stainless steel material need to regular maintenance,Rinsing them with fresh water after using and apply anti-rust Lubricating oil ,etc.
3. This product is suitable for inflatable boat that the length is less than 4.5m, the screws provided along with are suitable for the thickness of the transom is 36mm and less than 36mm.
4. The wheel is pneumatic wheel ,it's not for highway use,without bearing,it's suitable for short distance use by manual dragging. Please don't use car, motorcycle or battery car to drag fast, prevent the wheels to be damaged.
5. Please add lubricating oil or Lithium-base grease into bearing hole and bearing sleeve regularly.
6. The recommended inflation pressure of inflation wheel is 25P. S. I,Don' t inflate it too fast.