

VEVOR[®]

**MUG HEAT PRESS MACHINE
USER MANUAL**

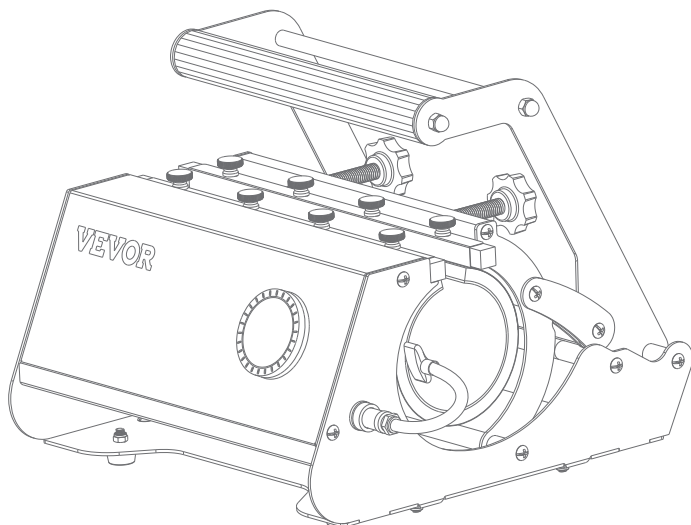

Max. diameter: 87 mm Max. length: 250mm

Up to 30OZ stainless steel cup can be made

NEED HELP? CONTACT US!

Have product questions? Need technical support? Please feel free to contact us:

CustomerService@vevor.com

This is the original instruction, please read all manual instructions carefully before operating. VEVOR reserves clear interpretation of our user manual. The appearance of the product shall be subject to the product you received. Please forgive us that we won't inform you again if there is any technology or software updates on our product.



Warnings must be followed carefully to avoid body injury.

INTRODUCTION

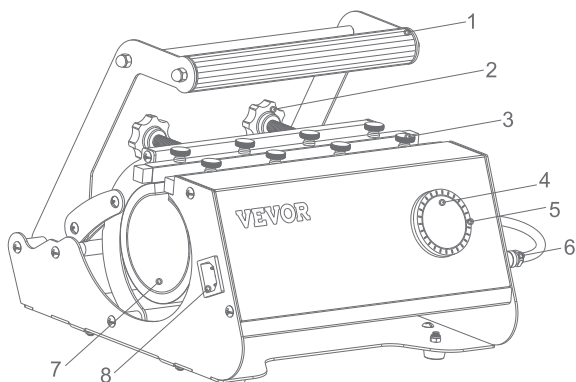

1.Aluminum alloy handle

2.Pressure adjusting knob

3.Screw

4.LED Display

5.Setting knob

6.Aviation connector

7.Mug heater

8.Power socket

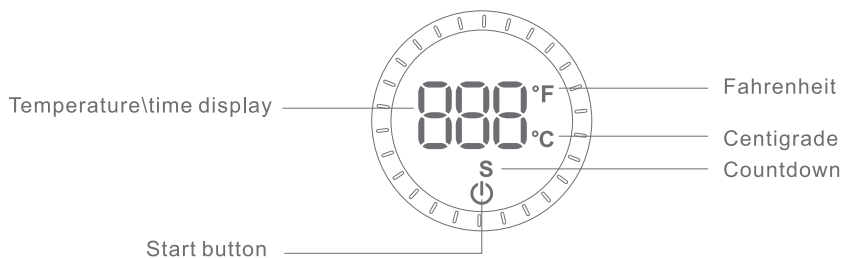

Temperature\time display

Start button

Fahrenheit

Centigrade

Countdown

Accessories list

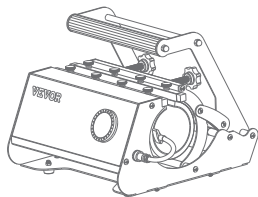

Main machine

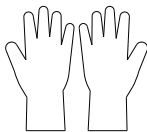

Gloves



Power cord



User manual

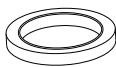

Film

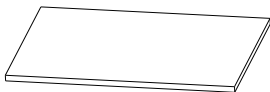

Transfer paper

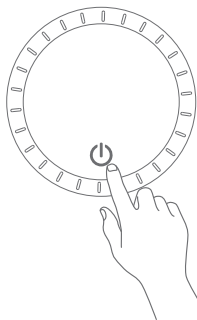

1.Startup

After power on, short press the start button to start the machine.
After startup, the machine will automatically heat up.

2.Shutdown

Press and hold the start button for 3s to shut down.

3.Auto shutdown

The machine will automatically shut down if there is no operation within 30min.

Temperature unit conversion °F ⇌ °C

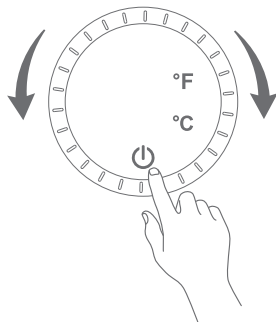

1. In shutdown state
2. Press and hold the start button for 6s.
3. Turn the switch to select the required temperature unit.
4. Short press the start button to start the machine.

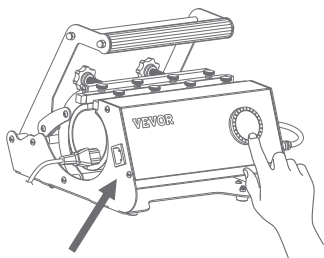

Start hot stamping

1. Plug in the power cord and turn on the power
2. Short press the start button to start the machine
3. Set printing temperature and time

Parameter setting

Temperature setting:

1. Turn the display half a turn to the right.
2. Enter the temperature setting mode after a beep sound.
3. Turn the switch to the right again to increase the temperature (+).
4. Turn the switch to the left again to reduce the temperature (-).

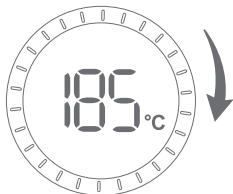

Time setting:

1. Turn the display half a turn to the left.
2. Enter the time setting mode after a beep sound.
3. Turn the switch to the right again to increase the time (+).
4. Turn the switch to the left again to reduce the time (-).



Ready to start

Parameter setting

1. Turn the display for a half turn.
2. Enter the setting mode after a beep sound.
3. Set corresponding parameters according to material type.

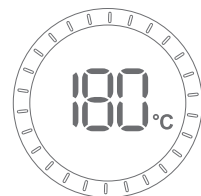

185°C 210s

11oz mug presses

185°C 260s

15oz mug presses

185°C 90s

25oz aluminum pot cup

185°C 150s

30oz stainless steel cup

It is normal that the temperature will be slightly higher when the machine works for the first time.

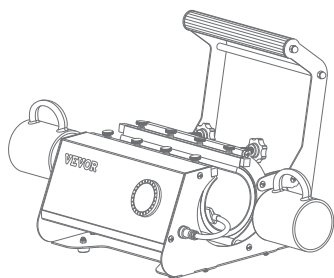

Hot stamping process

1. Make sure that the machine reaches the set temperature before transfer printing.
2. Stick the picture on the mug
3. Hold the handle and open the machine
4. Put the mugs in from the left and right
5. Press down the handle
6. Press the countdown button to start countdown

Tips:

1. Increase the transfer time if the color of the transferred pattern is too light.
2. Reduce the transfer time if the color of the transferred pattern is too dark.

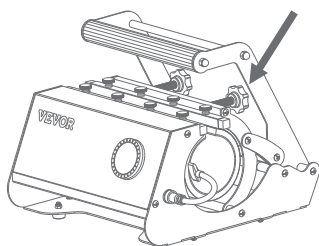

Pressure adjustment

1. The pressure can be adjusted manually for different sizes of mugs
2. Turn the handwheel clockwise to increase the pressure
3. Turn the handwheel counterclockwise to reduce the pressure

Tips:

Please try to keep the pressure balance at both sides.

ELECTRICAL DIAGRAM

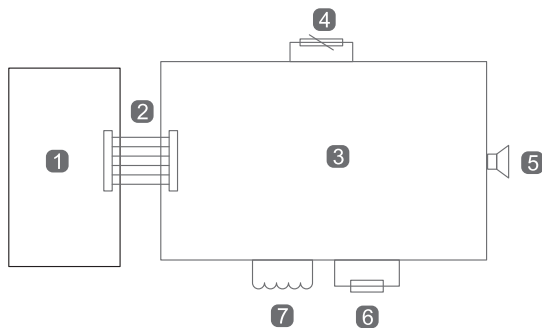

- 1 Main Control Board
- 2 Connect the cable
- 3 Power Strip
- 4 Down temperature sensor
- 5 Buzzer
- 6 Thermal cutoff
- 7 Heating Filament

MAIN BOARD WIRING DIAGRAM

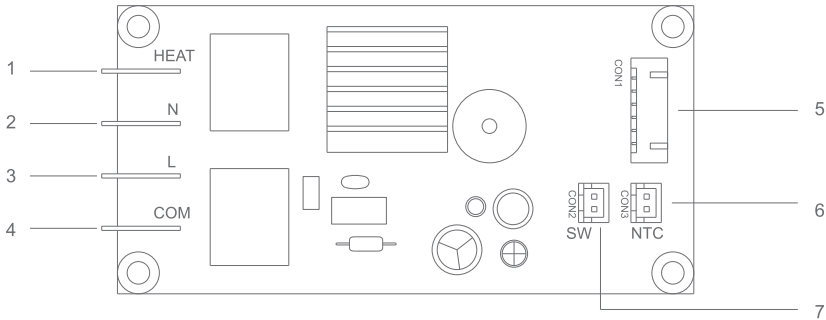

- 1.Output zero line 2.Input zero line 3.Input live line 4.Output live line
5.Display 6. Temperature probe 7.Sensor switch (backup)

TYPE X CONNECTION

If the supply cord is damaged, it must be replaced by a special cord or assembly available from the manufacturer or its service agent.

SAFETY INSTRUCTION

Before operating this unit, please read these instructions completely and save them.

Notice:

- 1.Keep unplug when moving the machine.
- 2.Keep unplug when installing accessories.
- 3.Place on a flat and stable platform and operate under ventilated conditions.
- 4.Wear special protective equipment when operating the machine

WARNING

Improper use may result in electric shock, fire, personal injury and other damage.

- 1.Do not use this machine in a hazardous location.
- 2.Do not use when the machine is not working properly.
- 3.Do not allow children or adults who do not understand this manual to operate this machine.
- 4.Do not disassemble and repair this machine.
- 5.Do not use an unsuitable AC outlet.
- 6.Do not touch the heating plate when the machine heating



PRODUCT PARAMETERS

Name: Mug heat press machine	
Heating method: Electric heating coil	
Rated voltage/frequency: 220-240V~ 50Hz For European users	
Rated voltage/frequency: 120V~ 60Hz For US users	
Rated power: 620W	
Temperature range: 40°C-210°C(104°F-410°F)	Time range: 1-999s
Model: F270	
Press pad size: L 250mm, printing diameter 87mm	
Net weight:7.0kg Gross weight:7.9kg	
Outer box size: 375x380x328mm	

WARRANTY

Type	Items	Period
Whole machine	Parts of machine (excl. accessories)	1 year

COMMON FAULT ANALYSIS

Fault phenomenon	Faults Causes and Solutions
Machine temperature does not rise	Reason1: The aviation connector wire is not properly inserted. Reason2: The electric power of the mug pad is broken. Replacing the mug pad. Reason3: The main board has no current output (the main board does not supply power to the toast coaster). Replace the motherboard.
Display error	Reason1: Is that the aviation connector is not inserted properly. Reason2: Is the aviation joint temperature probe wire broken.

This product is subject to the provision of european Directive 2012/19/EC. The symbol showing a wheelie bin crossed through indicates that the product requires separate refuse collection in the European Union. This applies to the product and all accessories marked with this symbol. Products marked as such may not be discarded with normal domestic waste, but must be taken to a collection point for recycling electrical and electronic devices.



This device complies with Part 15 of the FCC Rules.Operation is subject to the following two conditions:(1)This device may not cause harmful interference, and (2)this device must accept any interference received,including interference that may cause undesired operation.

Manufacturer:Yiwu Sunmeta Technology. Co., Ltd
Address: NO.5 Xinpan Road,Shangxi Toen,Yiwu City,Zhejiang province,China
UK Importer: FREE MOOD LTD
Address: 2 Holywell Lane, London, England, EC2A 3ET
EU Importer: WAITCHX
Address: 250 bis boulevard Saint-Germain 75007 Paris

UK	REP
----	-----

EUREP UK LTD
UNIT2264,100 OCK STREET,ABINGDON
OXFORDSHIRE ENGLAND OX14 5DH

EC	REP
----	-----

EUREP GmbH
Unterlettenweg 1a, 85051 Ingolstadt,Germany

Made in China

VEVOR[®]

E-mail: CustomerService@vevor.com