

VEVOR[®]

TOUGH TOOLS, HALF PRICE

Technical Support and E-Warranty Certificate www.vevor.com/support

PORTABLE MINI FRIDGE

MODEL NUMBER: MFA-10L-C

We continue to be committed to provide you tools with competitive price.

"Save Half", "Half Price" or any other similar expressions used by us only represents an estimate of savings you might benefit from buying certain tools with us compared to the major top brands and does not necessarily mean to cover all categories of tools offered by us. You are kindly reminded to verify carefully when you are placing an order with us if you are actually saving half in comparison with the top major brands.

VEVOR[®]

TOUGH TOOLS, HALF PRICE

PORTABLE MINI FRIDGE

MFA-10L-C

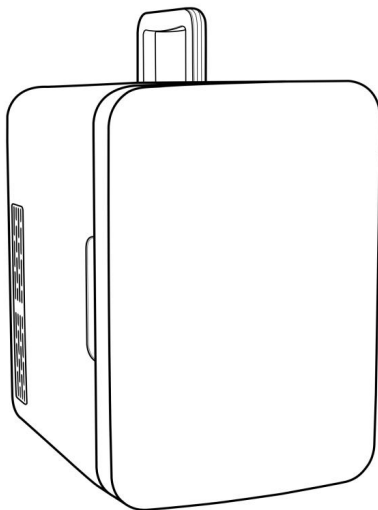

NEED HELP? CONTACT US!

Have product questions? Need technical support? Please feel free to contact us:



CustomerService@vevor.com

This is the original instruction, please read all manual instructions carefully before operating. VEVOR reserves clear interpretation of our user manual. The appearance of the product shall be subject to the product you received. Please forgive us that we won't inform you again if there is any technology or software updates on our product.

THERMOELECTRIC COOLER AND WARMER

Thanks for choosing our products and being our valued customer!

Safety Instructions

WARNING: Read all safety warnings, instructions, illustrations and specifications provided with this electrical appliances. Failure to follow all instructions listed below may result in electric shock, fire and/or serious injury.

SAVE THESE INSTRUCTIONS for future reference.

WARNING:

1. This appliance is not intended for use by persons (including children) with reduced physical, sensory or mental capabilities, or lack of experience and knowledge, unless they have been given supervision or instruction concerning use of the appliance by a person responsible for their safety.
2. Children should be supervised to ensure that they do not play with the appliance.
3. Do not store explosive substances such as aerosol cans with a flammable propellant in this appliance.
4. Suitable for camping use.
5. The appliance shall not be exposed to rain.
6. If the supply cord is damaged, it must be replaced by the manufacturer or its service agent or a similarly qualified person in order to avoid a hazard.
7. This appliance is intended to be used in household and similar applications such as
 - staff kitchen areas in shops, offices and other working environments;
 - farm houses and by clients in hotels, motels and other residential type environments;
 - bed and breakfast type environments;
 - catering and similar non-retail applications.
8. Please according to local regulations regarding disposal of the appliance for its flammable blowing gas. Before you scrap the appliance, please take off the doors

to prevent children trapped.

Disposal information



This product is subject to the provision of European Directive 2012/19/EU. The symbol showing a wheeled bin crossed through indicates that the product requires separate refuse collection in the European Union. This applies to the product and all accessories marked with this symbol. Products marked as such may not be discarded with normal domestic waste, but must be taken to a collection point for recycling electrical and electronic devices.

FCC statement:

This device complies with Part 15 of the FCC Rules. Operation is subject to the following two conditions: (1) This device may not cause harmful interference, and (2) this device must accept any interference received, including interference that may cause undesired operation.

PRODUCT CHARACTERISTICS

TEMPERATURE RETENTION - Our mini thermoelectric fridge is popular with travelers and drivers. It can keep food and drinks cool in the summer and warm in winter.

STORE COSMETICS - It is popular with skincare lovers and travelers! Use it to store and protect your skincare products. Save your time and extend the validity of cosmetics.

UNMATCHED PORTABILITY - Carrying handle and small size makes it perfect for travel or outdoor activities.

Applications

- For Your Traveling - Its small size and sleek design make it a perfect fit for anywhere; personal spaces, offices, dorms, road trips, tailgating, commuting, and more.
- For Your Skincare - This mini fridge is the perfect addition to your daily skincare routine for storing your favorite products.
- For Your Food or Drink - The 10L High Capacity Fridge fits up to twelve 12-oz.soda/beer/drink cans! Help your products last longer and place them in their own little home to prolong their shelf life and ensure they don't accumulate bacteria.

Attachment: Outdoor or Indoor

Use Operation Guide

1. Make sure the switch at the side of the cooler and warmer is in OFF state, and then insert the plug of the power cord into the socket of the unit.
2. Insert and connect the respective plugs.
3. Cooling: Set the power switch at the position of COLD. The green indicator will be on, indicating that the unit is in cooling mode.
4. Heating: Set the switch at the position of WARM. The red indicator will indicate the unit is in heating mode.

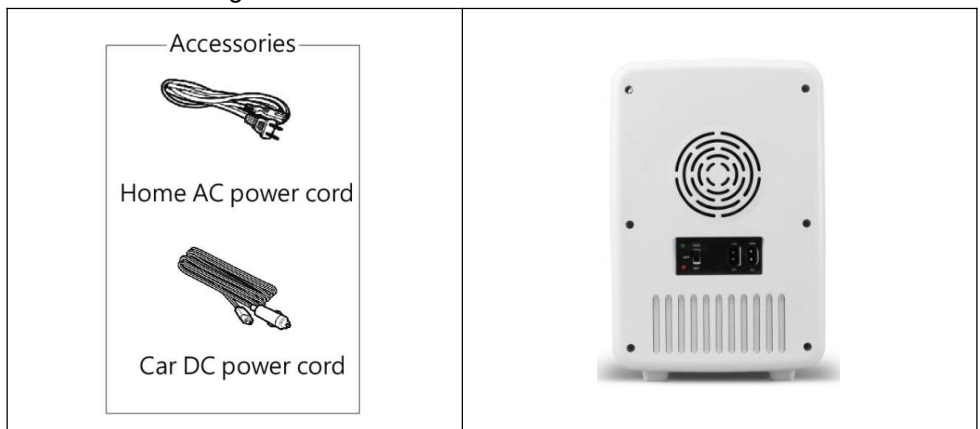

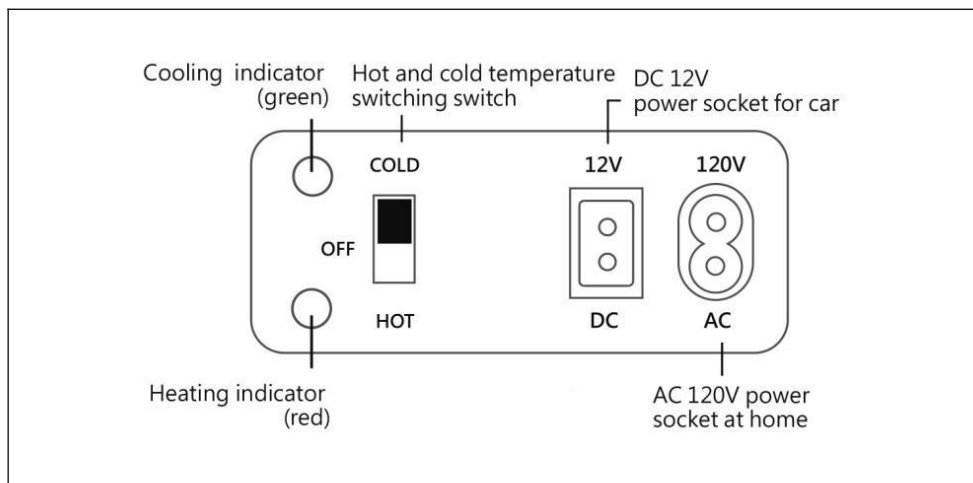

When Car Power is Used (DC 12V, the appliance of products is subject to the types of cars)

- 1.The car engine is required.
- 2.Turn the Cold/Warm switch to the right side.
- 3.Connect and insert the plug of DC power cord into the fridge and the socket of the car lighter.

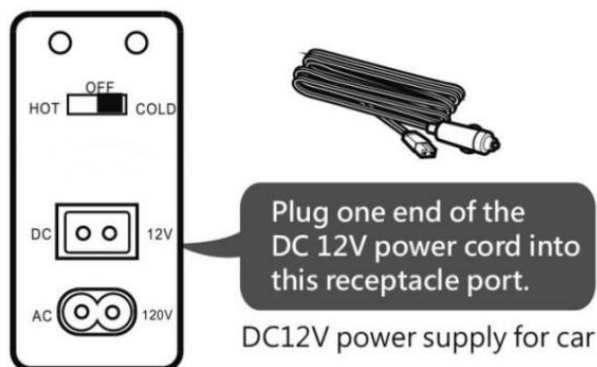

When the Household Power is Used (AC 120V/220-240V)

- 1.Turn the Cold/Warm switch to the right side.
- Connect the AC power cord (household power cord) with the household socket of

the product.

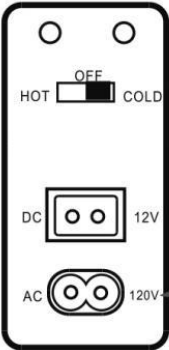

Plug one end of the AC 120V power cord into this outlet port; then plug the other end into a household 120V~/60Hz outlet.

AC120V power supply for household

Technical Specifications

Model No.	MFA-10L-C	MFA-10L-C
Capacity	10L	10L
Voltage	AC 120V/60Hz DC12V	AC 220-240V/50 60Hz DC12V
AC Power	Cooling: 50W Heating: 45W	Cooling: 50W Heating: 45W
DC Power	Cooling: 45W Heating: 40W	Cooling: 45W Heating: 40W
Below ambient temperature	60.8-68°F	16-20°C
Heating temperature	113-131°F	45-55°C
Plug type	USA plug DC plug	EU plug DC plug

Electrical Schematic

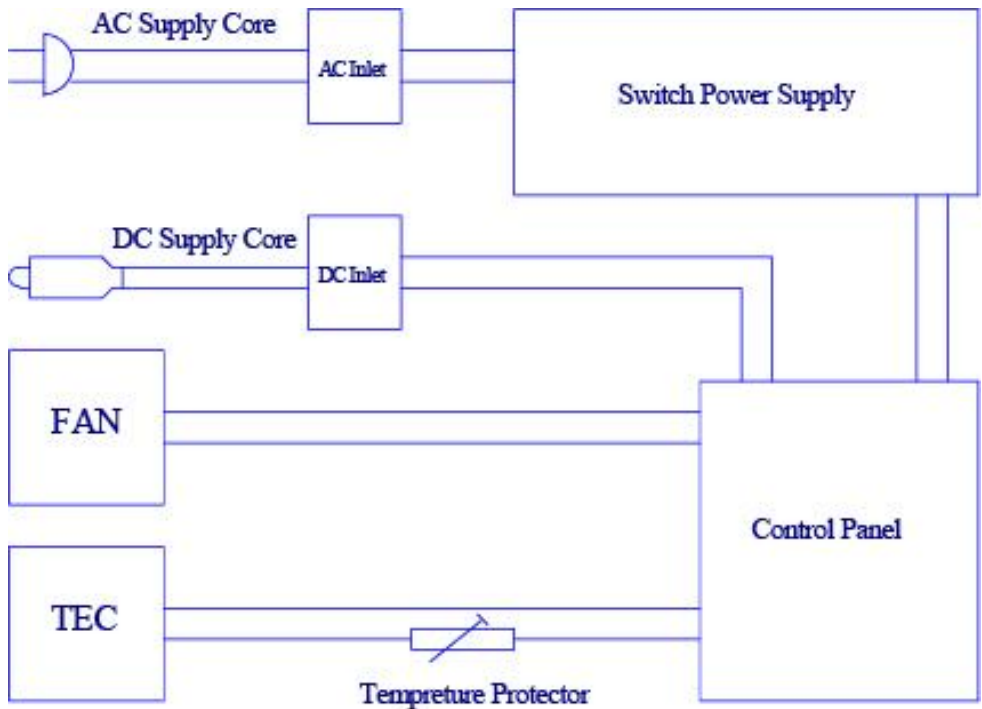

Target Temperature

The temperature inside the refrigerator will not immediately reach the target temperature when it first starts to run.

Generally, it takes about 2 hours to reach the target temperature. The lower limit temperature of the refrigerator varies depending on the room temperature.

- When the room temperature is 77° F(25°C), the temperature can be refrigerated to about 41-44.6° F(5-7°C).
- When the room temperature is 77° F(25°C), the temperature can be kept warm to about 113-131° F(45-55°C).
- The temperature inside the refrigerator is determined by the number of times the front door is opened and closed and the number of items stored in the refrigerator.
- When switching between refrigerator and keep warm function, please turn on the refrigerator temporarily for more than 1 hour.
- When switching between the keep warm function, the temperature inside the refrigerator will become hot, so please be careful of hot hands when opening the front door to retrieve a tin can for keeping warm beverages (such as coffee). When you open the front door to pick up the cans, let's note that they are hot.
- When using the cooling function, it is recommended to use it at a room temperature of 77° F(25°C) or below.

Ventilation and Heat Dissipation Precautions

Warning

- Never use in a car powered by 24V, or in a home powered by anything other than 120V or 220-240V. It will cause malfunction and fire.
- This product should not be used in the presence of water, and avoid using it in high temperature to avoid malfunction, electric shock and other accidents.
- The decomposition, transformation, and high of the body and power cord will lead to malfunction and fire.

Caution

- In summer, do not place the refrigerator in the car, trunk, or other high-temperature places to avoid this product.
- Do not place the refrigerator in the car and the trunk when the temperature is high in the summer.

- When using the product in the car, be sure to turn on the engine, and if the engine is turned off, disconnect the DC power cord. Unplug the DC power cord.
- Unplug the power cord from the AC outlet or DC cigarette lighter outlet when the product is not in use for a long time.
- Do not block the air inlet or the fluorine outlet, as this is the reason why the unit does not cool or heat up.

VEVOR[®]

TOUGH TOOLS, HALF PRICE

Technical Support and E-Warranty Certificate

www.vevor.com/support