

VEVOR[®]

TOUGH TOOLS, HALF PRICE

Support and E-Warranty Certificate <https://www.vevor.com/support>

WIRE STRIPPING MACHINE INSTRUCTION MANUAL

We continue to be committed to providing you with tools at a competitive price. "Save Half", "Half Price" or any other similar expressions used by us only represent an estimate of savings you might benefit from buying certain tools with us compared to the major top brands and do not necessarily mean to cover all categories of tools offered by us. You are kindly reminded to verify carefully when placing an order with us if you are actually saving half compared to the top major brands.

VEVOR®

TOUGH TOOLS, HALF PRICE

WIRE STRIPPING MACHINE

MODEL:SD-002

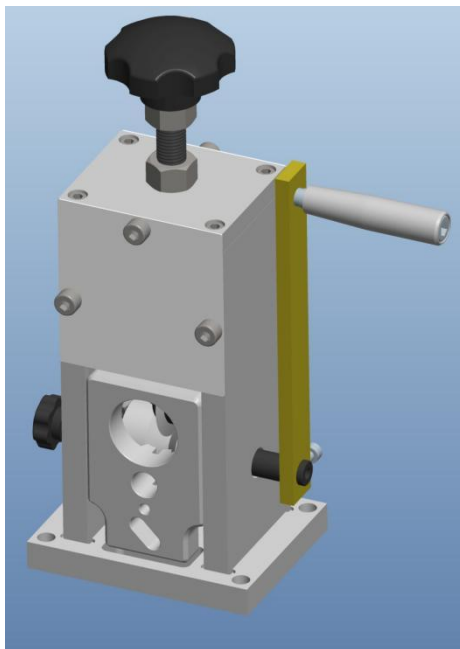

NEED HELP? CONTACT US!

Have product questions? Need technical support? Please feel free to contact us:

 CustomerService@vevor.com

This is the original instruction, please read all manual instructions carefully before operating. VEVOR reserves a clear interpretation of our user manual. The appearance of the product shall be subject to the product you received. Please forgive us that we won't inform you again if there are any technology or software updates on our product.

This is the original instruction, please read all manual instructions carefully before operating. VEVOR reserves a clear interpretation of our user manual. The appearance of the product shall be subject to the product you received. Please forgive us that we won't inform you again if there are any technology or software updates on our product.

Technical Parameter

Model	Dimension (L*W*H mm)	Weight (kg)	Stripping Range (mm)
SD-002	150×102×315	3.7kg	Φ1.5~Φ38

Note: this machine is not applicable to silicone rubber cables or armored cables.

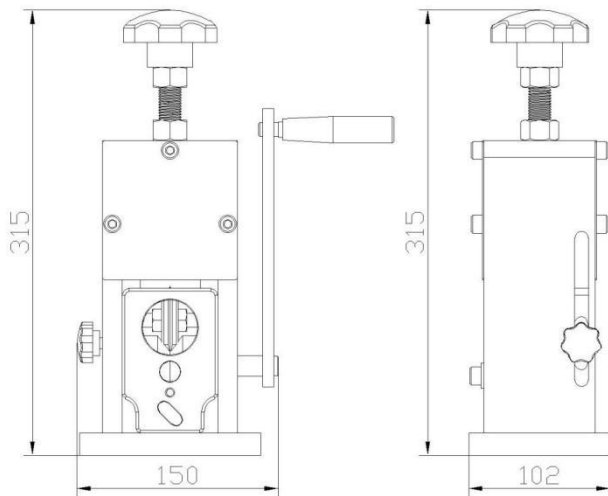

Parts List

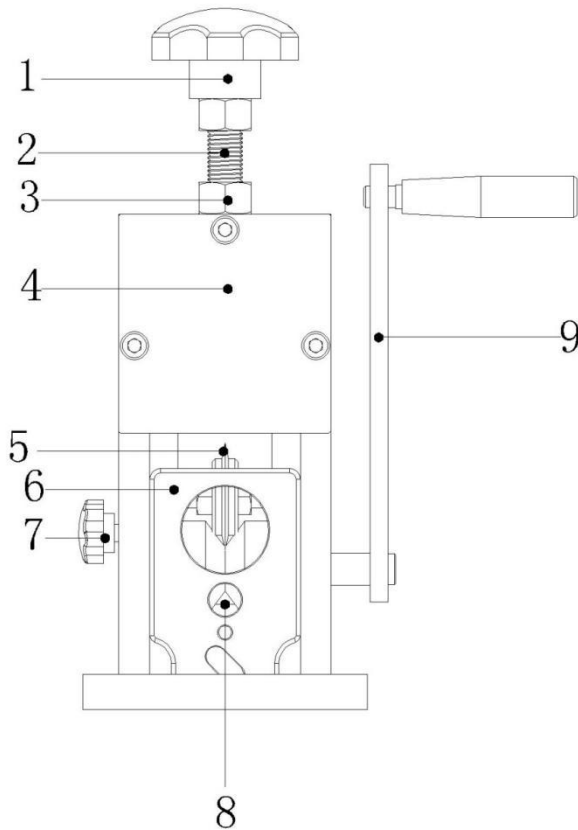

1:M16 plastic nut for regulating blade up and down

2: M16 screw rod for regulating blade up and down

3: Nut for screw rod

4:Panel

5:Blade

6: Incoming panel

7:Screw for tightening incoming panel

8: Feeding hole

9:Handle

Accessories

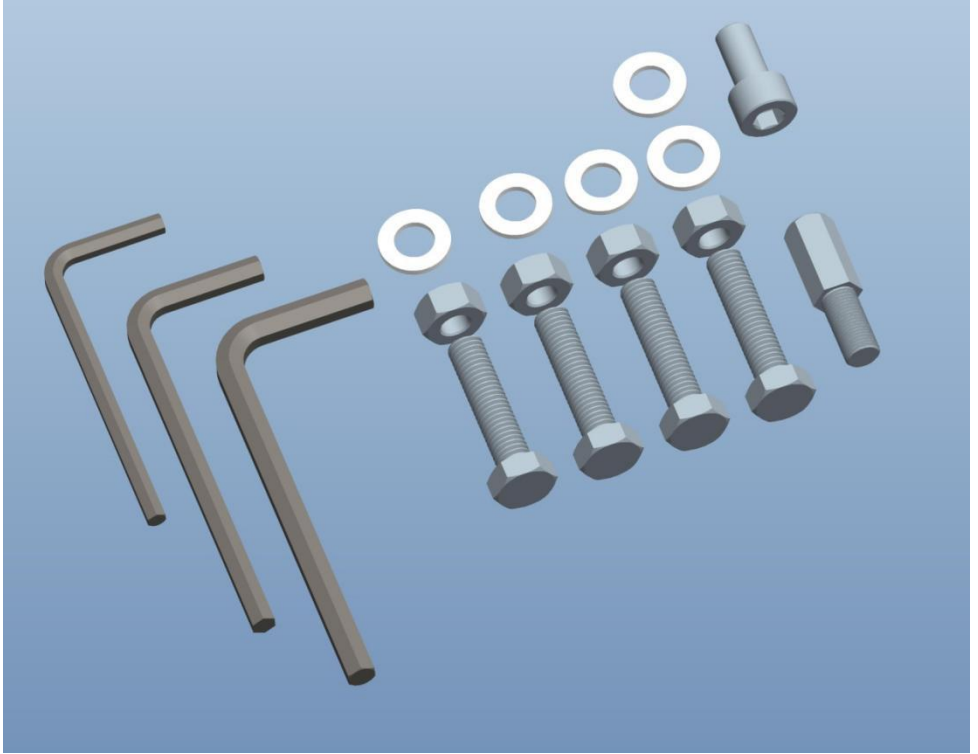

Details:

- 1、 One 4# allen key
- 2、 One 5# allen key
- 3、 One 6# allen key
- 4、 One 10# screw for connecting the electric drill
- 5、 Four M8 Screw nut
- 6、 Four M8*35 screw
- 7、 One M8*16 inner-hexagon screw、 Five D8 gaskets
- 8、 One 10#screw for connecting the electric drill

Operation Instruction

1. Select the appropriate feeding hole according to the wire diameter (As shown below) .

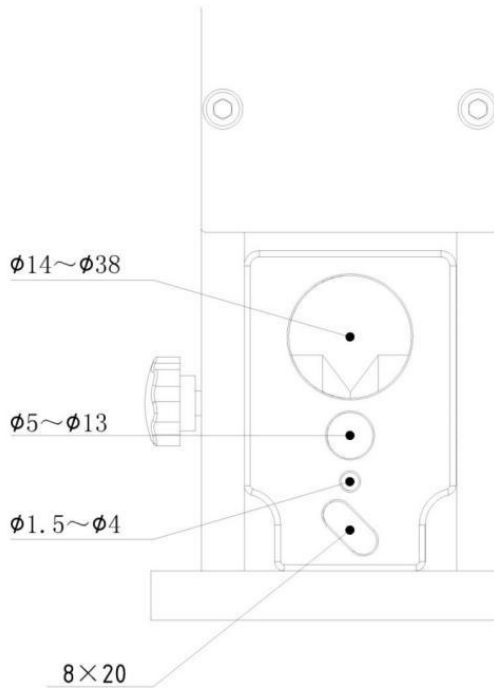

2. During wire stripping, the center of the blade must be collinear with the center of the rolling gear (as shown below).

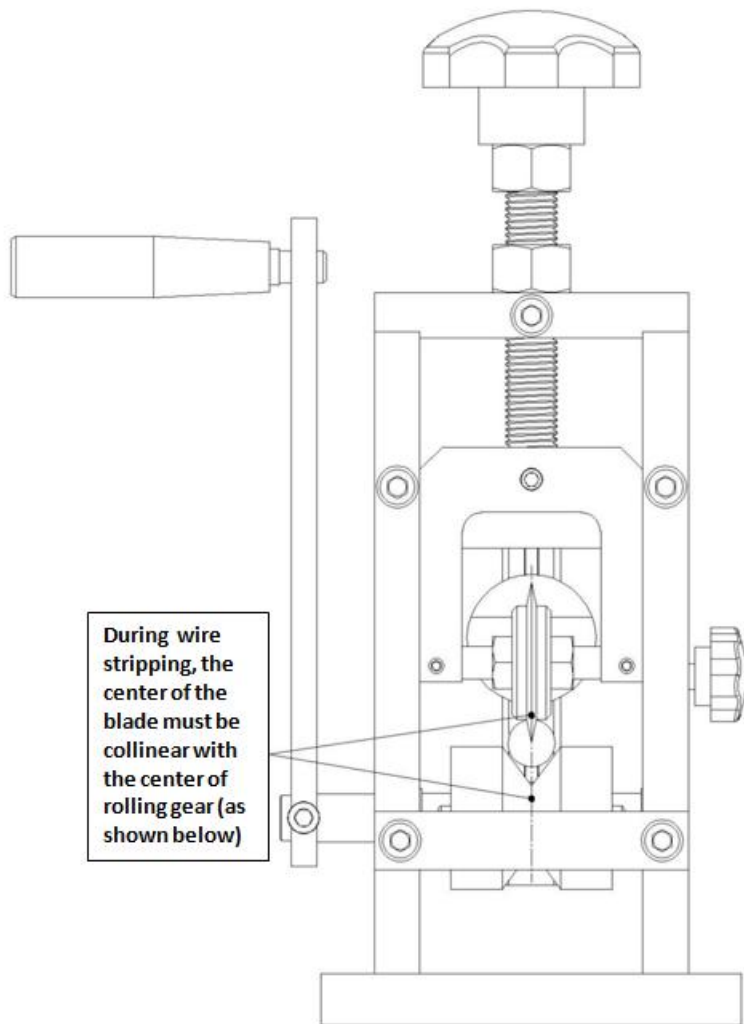

3. According to the thickness of the wire, adjust the height of the blade through the M16 screw nut above the machine so that the blade can cut the wire skin without damaging the copper core (as shown in the following figure).

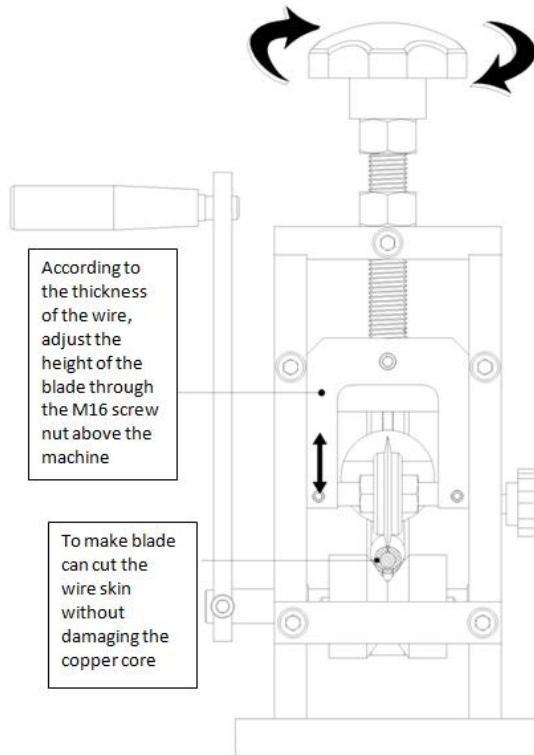

4. When stripping, adjust the height of the feeding plate according to the thickness and hardness of the wire (generally, the feeding panel should be adjusted higher for thick and hard wires and lower for soft and thin wires). In this way, the wire is not easy to be eccentric when stripping.

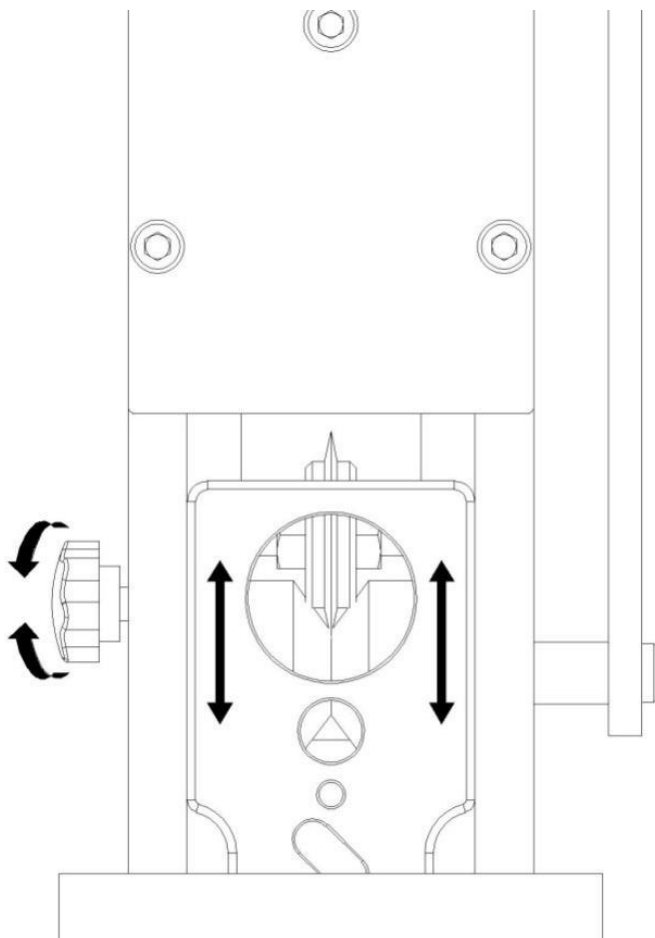

5. When the diameter of the wire to be treated does not exceed 20mm, the two rolling gears need not be separated

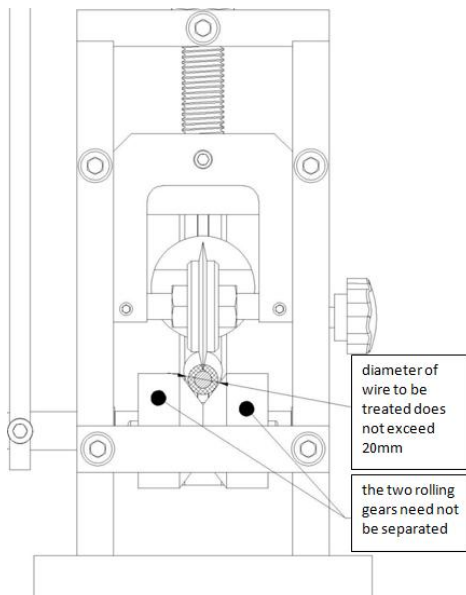

6. When the wire diameter to be treated exceeds 20mm, the two rolling gears need to be separated by loosening the two screws in the gears.

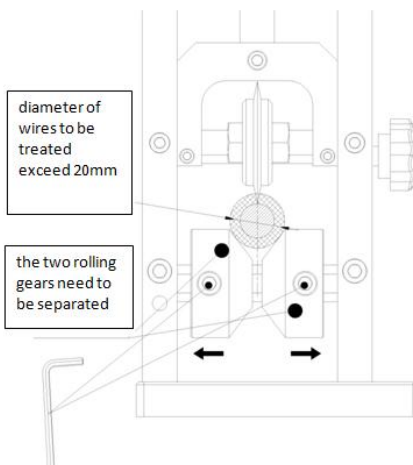

7. If the machine cannot strip the wire, there may be several reasons:

- ①. The diameter of the stripped wire is too small (the diameter of the wire to be treated, including the outer skin, shall not be less than 1.5mm).
- ②. The blade's center is not on the same line as the rolling gear's center.
- ③. The blade is not sharp.

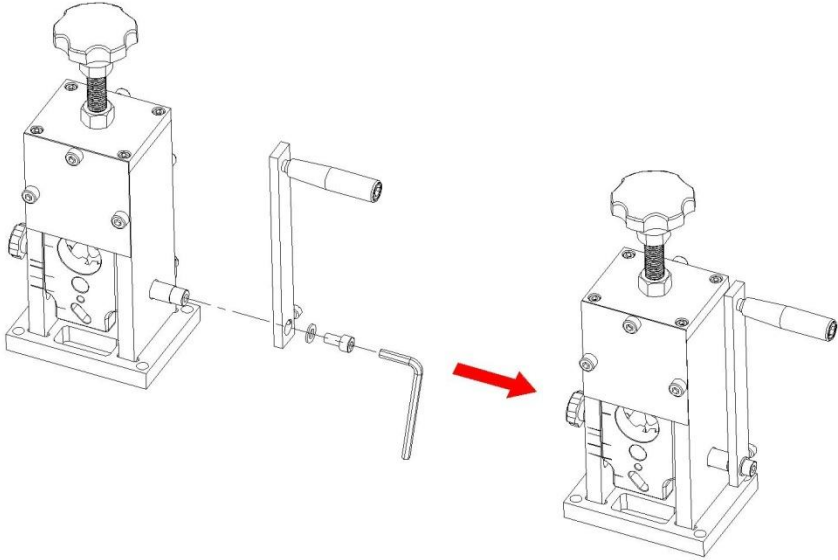

8. When the machine is operated by hand, install the handle (as shown in the above figure)

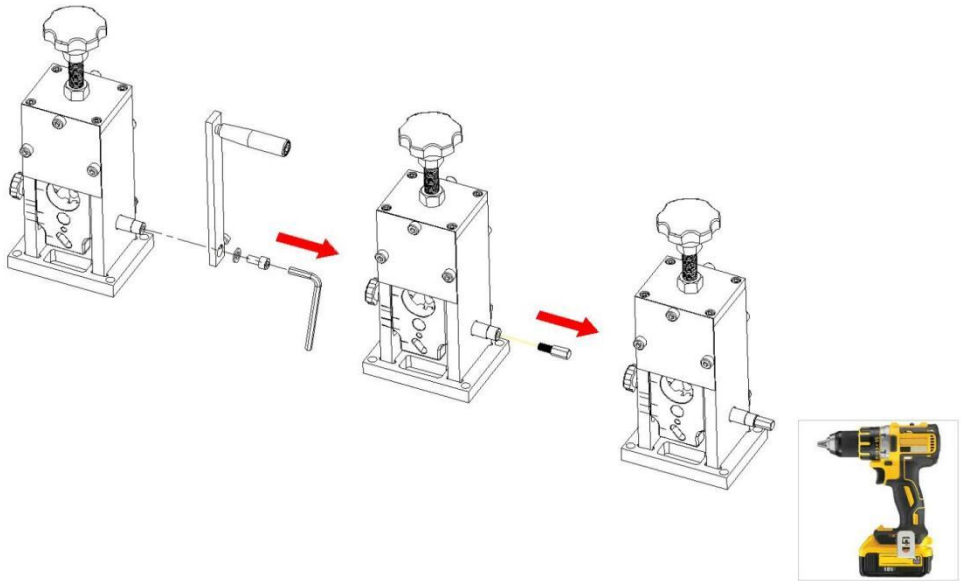

Diagram of Removing Handle and Installing Electric Drill Screw

9. When the machine is driven by an electric drill, remove the handle first, then install the connecting screw for the drill (do not need to add a gasket), and use the electric drill last.

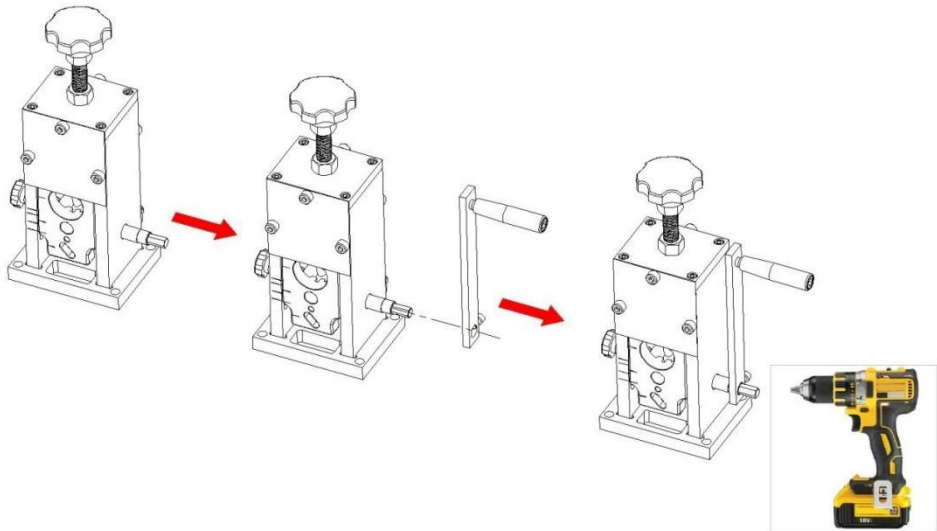
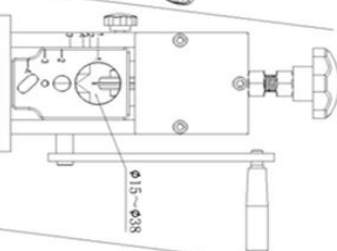
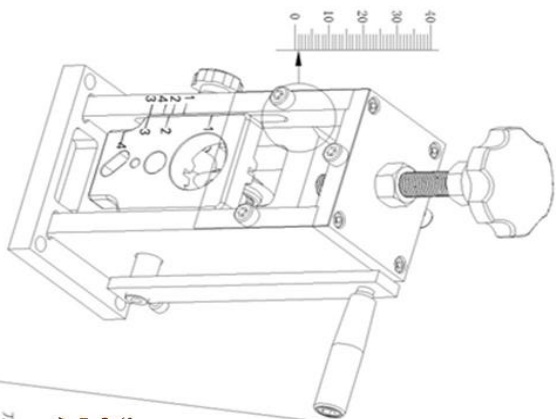

Diagram of removing the electric drill screws

10. First, assemble the handle, then hold the handle with one hand and use the electric drill with the other hand to turn the drill counterclockwise to remove the screw.

NOTE: Never put your hand in when the machine is running (you must stop the machine before checking, debugging, and troubleshooting the machine). To avoid cutting your hand, do not touch the blade directly with your hand.



Scale mark of the inlet hole corresponds to the scale mark on the machine body Around 1 to 1

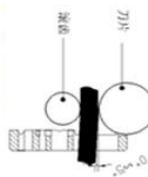

The inlet hole is basically aligned with the tangent line or slightly lower

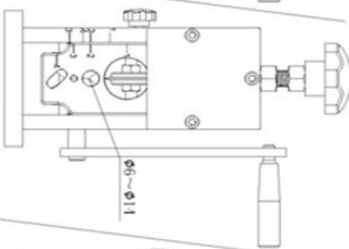

Scale mark of the inlet hole corresponds to the scale mark on the machine body Around 2 to 2

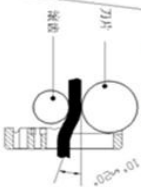

There is an obvious angle between the inlet hole and the tangent line

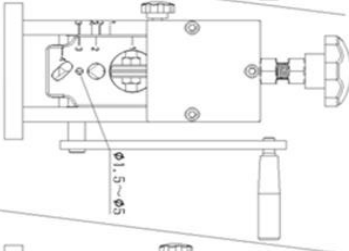

Scale mark of the inlet hole corresponds to the scale mark on the machine body Around 3 to 3

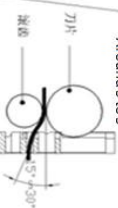

There is an obvious angle between the inlet hole and the tangent line

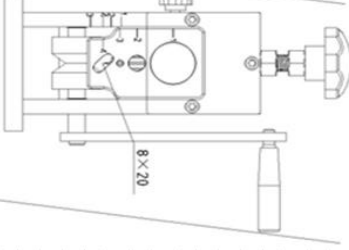

Scale mark of the inlet hole corresponds to the scale mark on the machine body Around 4 to 4

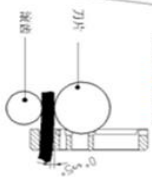

The inlet hole is basically aligned with the tangent line or slightly lower

Manufacturer:

Taizhou Senduo Environmental Protection Equipment Technology Co.,
Ltd.

Address:

Workshop B14, Xiaowufen Industrial zone, Luqiao Town, Taizhou
City,Zhejiang,China

Importer: WAITCHX

Address: 250 bis boulevard Saint-Germain 75007 Paris

Importer: FREE MOOD LTD

Address: 2 Holywell Lane, London, England, EC2A 3ET



EUREP UK LTD
UNIT 2264, 100 OCK STREET, ABINGDON
OXFORDSHIRE ENGLAND OX14 5DH



EUREP GmbH
Unterlettenweg 1a, 85051
Ingolstadt, Germany

VEVOR[®]

TOUGH TOOLS, HALF PRICE

Support and E-Warranty Certificate <https://www.vevor.com/support>