

Working Scenes:



INSTRUCTIONS

Using Steps Of Dent Lifter



1. Clean the surface of the depression

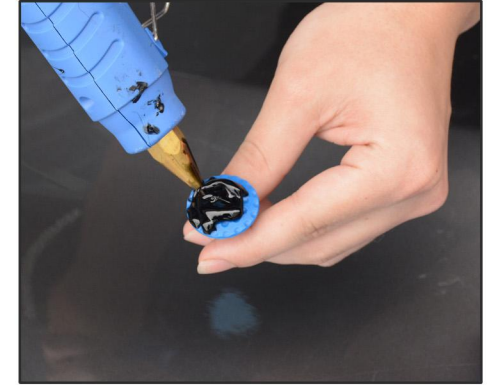

2. Heat the glue stick with a glue gun and apply it to the puller tabs



3. Attach the puller tabs to the depression, wait about 2 minutes

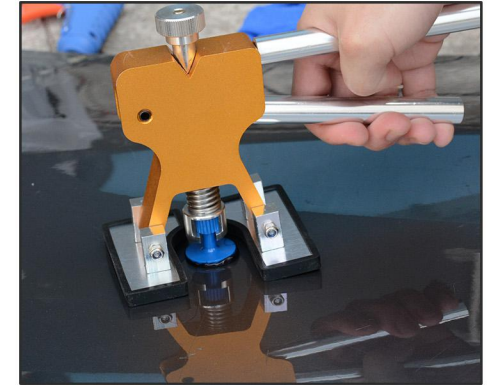

4. Place the dent lifter

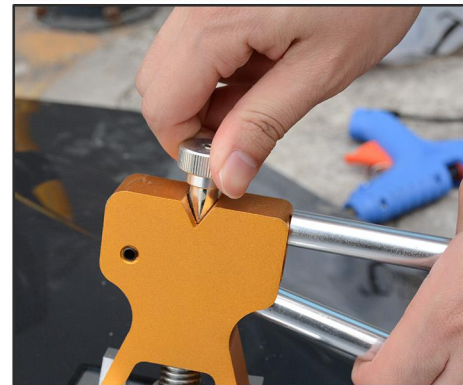

5. Adjust the height of the pull head to fit the puller tabs

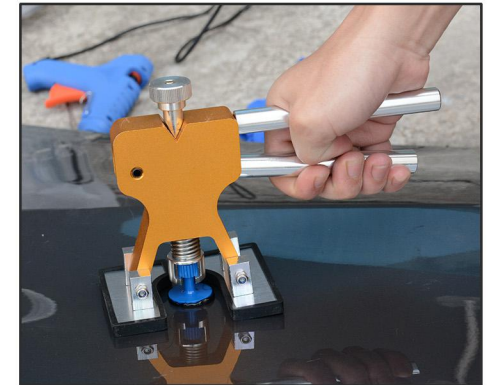

6. Pull the tabs slowly

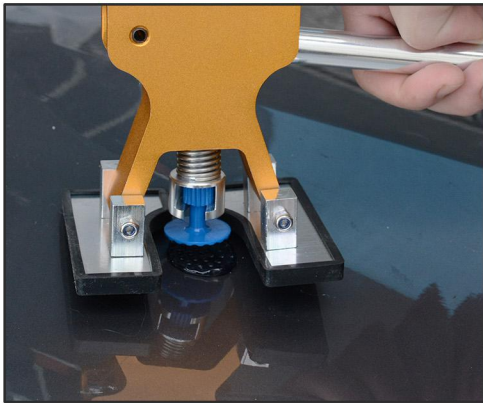

7.Until the head is separated from the glue



8.Spray a little alcohol

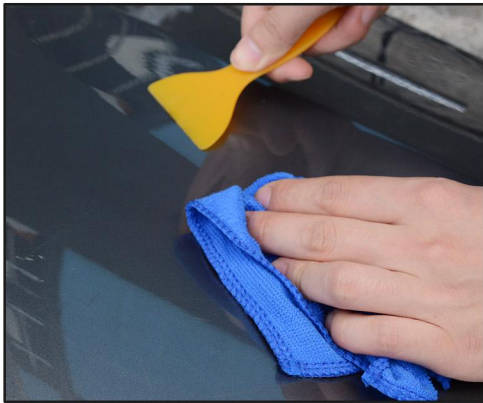

9.shovel off the glue with the scraper, Clean up with a rag

For finishing that process,you need dent lifter, puller tabs, glue gun, glue stick, scraper and spray bottle.

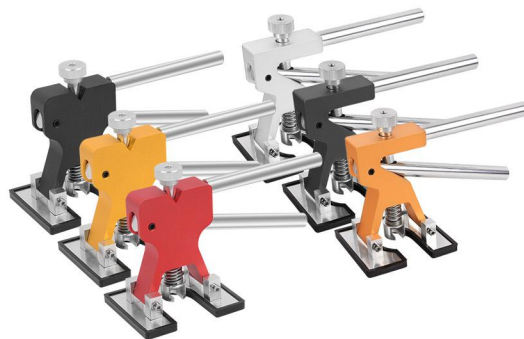

This instruction is applicable to all the dent lifter sold in our shop.

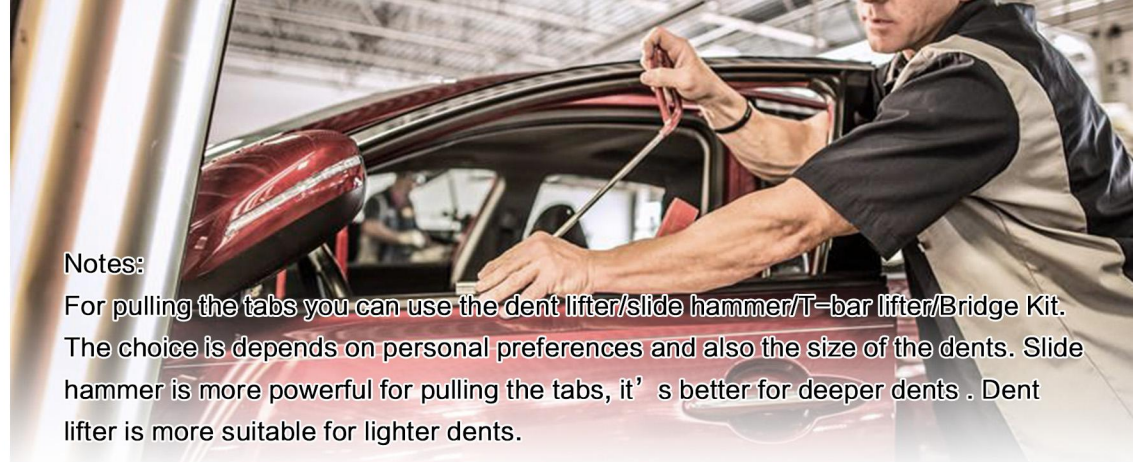

Notes:

For pulling the tabs you can use the dent lifter/slide hammer/T-bar lifter/Bridge Kit. The choice is depends on personal preferences and also the size of the dents. Slide hammer is more powerful for pulling the tabs, it' s better for deeper dents . Dent lifter is more suitable for lighter dents.

Store Recommendation:

