

# Instruction

## 一、 Picture description

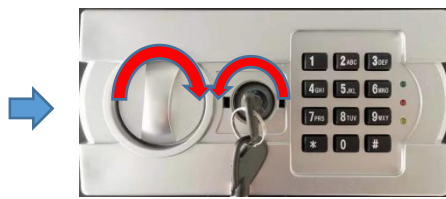

①Open the emergency key cover



②Insert the emergency key,turn it counterclockwise,and turn the Knob clockwise to open the door

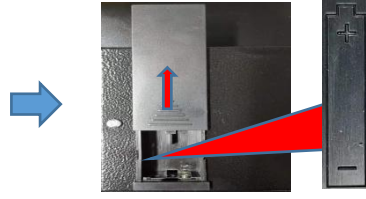

③Push the battery cover upward, install the battery an pay attention to the positive and negative pole



④Press the reset key to set or change the password



⑤The yellow light is on for a long time,input 3~8 digit password and Press"#(B)"to confirm

## I: Product Functional Description:

1: Yellow light is an input digital indicator light; The green light is the door opening indicator light; a red light is an under-pressure indicator light.

2: The static current is below 10UA.

3: dynamic current is 360MA.

4: the under-voltage voltage is 4.5V (+/-0.2V)

5: normal operating voltage: 4-7V

6: The system has no password memorization function.

## Two: open the door:

When entering the correct 3-8-bit password, press B(#), the buzzer "dripping", green light 6S, electromagnet suction 6S.

Note: after entering the wrong password, the buzzer rang "three downs" and the yellow light flashed three times, indicating that the input password was incorrect.

## Three: set the password;

(1) When setting the customer password, press the code change button, the yellow light shines twice, and the buzzer rings twice at the same time, then enter a 3-8-bit password. After pressing B(#) to confirm, the buzzer rang twice, and the yellow light shines twice and goes out. Represents the success of setting.

(2) When setting the main password, enter "00", then press the code change button, enter the 3-8-bit password. After pressing B(#) to confirm, the buzzer rang twice and the yellow light flashed twice and extinguished. Represents the success of setting.

## Four: the self-locking function of lost passwords:

1: Enter the wrong password three times in a row, the password lock will be automatically locked for 20 seconds, and the buzzer alarm will be alarmed.

2: Enter the wrong password six times in a row, the password lock will be locked for 5 minutes, and the buzzer will ring.

Note: during the self-locking process, any key input is unresponsive.

## Six: under-pressure function:

When the voltage is 4.5V (+/-0.2), the indicator light turns on and warns to replace the battery.