

VEVOR[®]

TOUGH TOOLS, HALF PRICE

Technical Support and E-Warranty Certificate www.vevor.com/support

MOTORCYCLE WHEEL CHOCK USER MANUAL

Model: TYGJ210084

We continue to be committed to provide you tools with competitive price. "Save Half", "Half Price" or any other similar expressions used by us only represents an estimate of savings you might benefit from buying certain tools with us compared to the major top brands and does not necessarily mean to cover all categories of tools offered by us. You are kindly reminded to verify carefully when you are placing an order with us if you are actually saving half in comparison with the top major brands.

VEVOR[®]

Motorcycle Wheel Chock

Model: TYGJ210084



NEED HELP? CONTACT US!

Have product questions? Need technical support? Please feel free to contact us:



CustomerService@vevor.com

This is the original instruction, please read all manual instructions carefully before operating. VEVOR reserves a clear interpretation of our user manual. The appearance of the product shall be subject to the product you received. Please forgive us that we won't inform you again if there are any technology or software updates on our product.



Safety & Warning

- Read and understand this entire manual before assembling, installing, operating, or servicing this product. Failure to follow these warnings and instructions can cause death, personal injury or damage to valuable property.
- Keep this manual for the safety warnings and precautions. The manual offers important information on how to assemble, use and maintain this product. Support load by appropriate means after lifting.
- Do not exceed rated capacity.
- Use safety equipment. Safety shoes, hard hat and work gloves must be used for applicable conditions.
- Dress appropriately. Never wear loose fitting clothing or jewelry when working. Contain long hair, and keep hair, clothing and gloves away from moving parts. Use common sense when working. Stay alert and concentrate when setting up and using the Motorcycle Wheel Chock. Never work while under the influence of alcohol, drugs or medications.
- Before transporting a motorcycle in a truck bed, secure the motorcycle with ropes, and/or tie-downs (not included). The vehicle's engine must be OFF and parking brake set before loading or unloading the motor-cycle into or out of the Wheel Chock. Do not exceed 55 MPH while transporting a motor-cycle in a truck bed.

Keep in mind that the warnings previously discussed cannot cover all possible events and circumstances. It is important that the person setting up and using this Motorcycle Wheel Chock use common sense at all times.

Specifications

Model Series	TYGJ210084
Maximum Load Capacity (lb)	1800
Fit Tire Diameter (inch)	15-21
Fit Tire Width (inch)	3-6.5
Net Weight (kg)	5.4
Gross Weight (kg)	6.6

Parts List

Part	Description	Qty	Part	Description	Qty
1	Frame	1	8	Spring Washer	8
2	Pivoting Bracket	1	9	Flat Washer	4
3	Stand	1	10	Bolt M10x30	2
4	Cover	4	11	Bolt M10x70	4
5	Hex Nut M10	6	12	Nylon Sleeve	4
6	Nylon Washer	2	13	Large Washer	4
7	Hex Bolt M10x20	4			

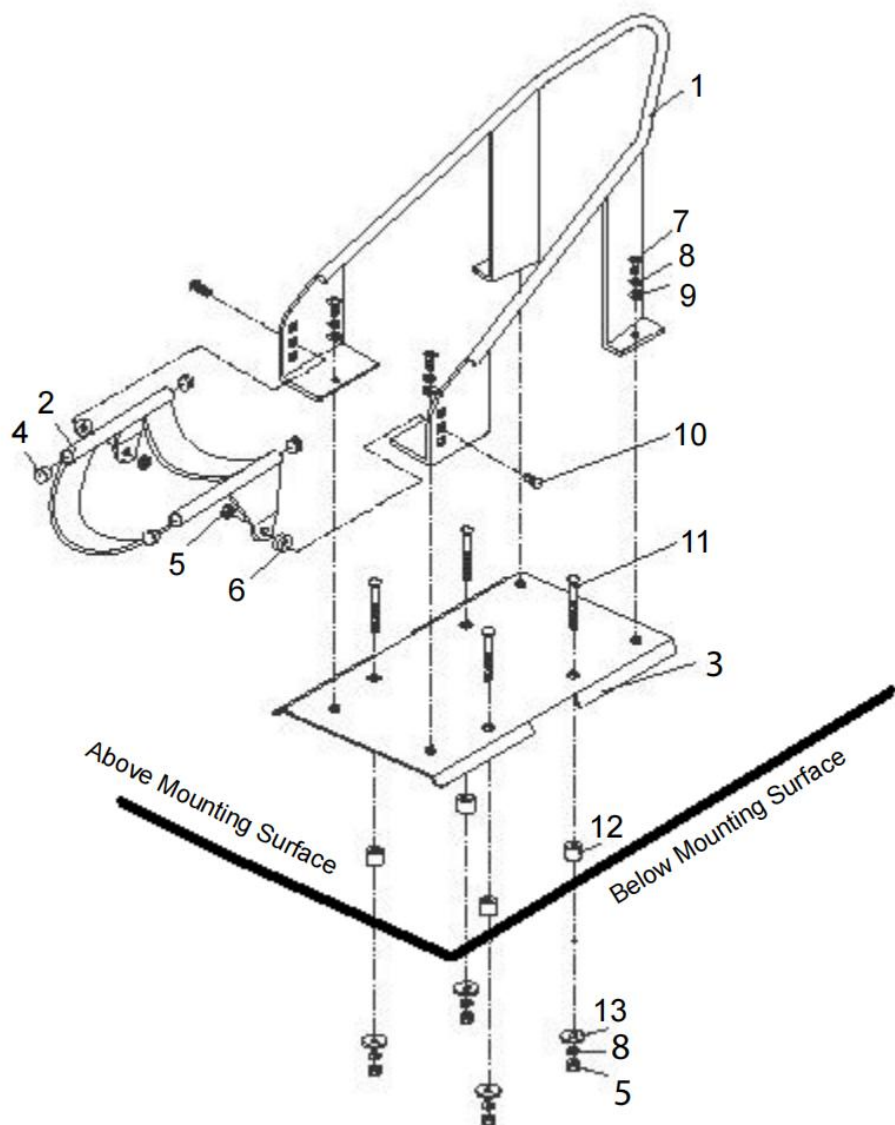

Mounting the Motorcycle Wheel Chock

1. This Wheel Chock must be mounted to a solid, level surface. It is designed to be of a truck, or on a motorcycle lift.
2. When mounting to a truck bed or on a motorcycle lift:

- A. Find the desired location and place the Stand (3) in the proper position. Use the 4 holes in the Stand as a template to mark where drilled holes need to be.
 - B. Using a steel cutting drill bit, drill the proper size holes for Bolts M10 (11).
 - C. Attach the Stand (3) to the surface by first inserting 4 Bolts (11) through the top of the Stand; put Nylon Sleeve (12) on each bolt from the underside of Stand.
 - D. Secure all Bolts by adding Large Washer (13), Spring Washer (8) and Hex Nut (5), all from underneath the truck bed or lift surface.
3. When mounting to a concrete floor:
- A. Locate the desired position for the Wheel Chock; consider size of the motorcycle and how much room is needed to maneuver the motorcycle in and out of the Wheel Chock. The concrete surface must be level, solid and capable of supporting heavy equipment.
 - B. Concrete anchors (not included) will be needed to secure the Stand (3) into the concrete.
 - C. Find the desired location and place the Stand (3) in the proper position. Use the 4 holes in the Stand as a template to mark where drilled holes need to be.
 - D. Use concrete drill bit to drill the appropriate sized holes.
 - E. Follow hardware manufacturer's instructions for properly securing concrete anchors in the cement. Then mount the Stand (3) to the concrete using the concrete anchors.

Using the Motorcycle Wheel Chock

1. See bracket adjustment positions in the photo on this page. The Pivoting Bracket can be adjusted to one of three positions depending on the size of the motorcycle wheel. Find the position that best locks the wheel in place when the wheel is rolled in and the Bracket pivots up to it's closed position.
2. The motorcycle is slowly rolled into the Wheel Chock when the Pivoting Bracket (2) is in the open, horizontal position as shown in the photo. As the wheel rolls in, the Pivoting Bracket will pivot upward and close, securing the motorcycle in the Wheel Chock.
3. If the motorcycle is going to be stored in the Wheel Chock for a length of time, it is recommended that additional stability supports are used (straps or rope).
4. To release the motorcycle from the Wheel Chock, slowly roll back the motorcycle away from the Wheel Chock.

Maintaining the Wheel Chock

Frequently check the condition of the Motorcycle Wheel Chock.

Make sure all components are in good condition. If the Wheel Chock becomes damaged through accident, or if any weld damage is noted, the product should be replaced. Check to make sure that all hardware is tightly secured in place. Keep the Wheel Chock clean.

Address: Baoshanqu Shuangchenglu 803long 11hao 1602A-1609shi
Shanghai

Imported to AUS: SIHAO PTY LTD, 1 ROKEVA STREETEASTWOOD
NSW 2122 Australia

Imported to USA: VEVOR STORE INC, 9448 RINCHMOND PL #E
RANCHO CUCAMONGA, California, 91730 United States of America



Pooledas Group Ltd
Unit 5 Albert Edward House, The Pavilions
Preston, United Kingdom

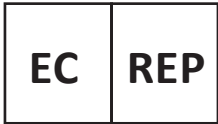

SHUNSHUN GmbH
Römeräcker 9 Z2021, 76351
Linkenheim-Hochstetten, Germany

Made In China

VEVOR[®]

TOUGH TOOLS, HALF PRICE

Technical Support and E-Warranty Certificate

www.vevor.com/support

Made In China

