

# **VEVOR<sup>®</sup>**

**TOUGH TOOLS, HALF PRICE**

Technical Support and E-Warranty Certificate [www.vevor.com/support](http://www.vevor.com/support)

## **4400 LBS ENGINE HOIST**

### **USER'S MANUAL**

We continue to be committed to provide you tools with competitive price.

"Save Half", "Half Price" or any other similar expressions used by us only represents an estimate of savings you might benefit from buying certain tools with us compared to the major top brands and does not necessarily mean to cover all categories of tools offered by us. You are kindly reminded to verify carefully when you are placing an order with us if you are actually saving half in comparison with the top major brands.

# VEVOR<sup>®</sup>

**4400 LBS  
ENGINE HOIST**

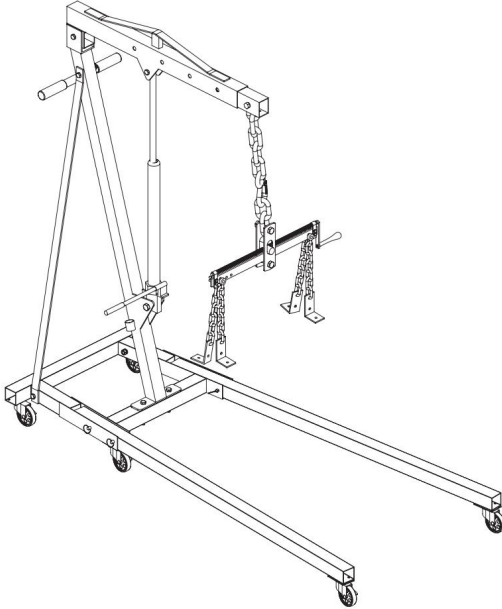

## **NEED HELP? CONTACT US!**

Have product questions? Need technical support? Please feel free to contact us:

 [\*\*CustomerService@vevor.com\*\*](mailto:CustomerService@vevor.com)

This is the original instruction, please read all manual instructions carefully before operating. VEVOR reserves a clear interpretation of our user manual. The appearance of the product shall be subject to the product you received. Please forgive us that we won't inform you again if there are any technology or software updates on our product.

## SPECIFICATION

ITEM	CAPACITY	N.W(kg)	G.W.(kg)
XXJD11002B	4400	71.4	72.9

## INSPECTION

- Inspect the equipment carefully before each use. Ensure the equipment is not damaged, excessively worn, or missing parts.
- Do not use the equipment unless it is properly lubricated.
- Using equipment that is not in good clean working condition or properly lubricated may cause serious injury.
- Inspect the work area before each use. Make sure it is free and clear of any potential hazards.

DO NOT OPERATE OR REPAIR THIS EQUIPMENT WITHOUT READING THIS MANUAL.

- To maintain the equipment and user safety, the responsibility of the owner is to read and follow these instructions.
- Inspect the equipment for proper operation and function.
- Keep instructions readily available for equipment operators.
- Make certain all equipment operators are properly trained; understand how to safely and correctly operate the unit.
- Allow unit operation only with all parts in place and operating properly.
- Use only genuine replacement parts.
- Service and maintain the unit only with authorized or approved replacement parts; negligence will make the equipment unsafe for use and void the warranty.
- Carefully inspect the unit on a regular basis and perform all maintenance as required.
- Store these instructions in the handle of your equipment.
- Keep all decals on the unit clean and visible.

## **WARNING!**

1. Study, understand, and follow all instructions before operating this device.
2. Do not exceed rated capacity.
3. Use only on hard, level surfaces, with less than 3 degrees of slope.
4. Mount and support only on areas of the engine as specified by the vehicle manufacturer.
5. No alterations shall be made to this product.
6. Only attachments and/or adapters supplied by the manufacturer shall be used.
7. Never work directly under a supported load.
8. Do not use this product for any use other than the manufacturer specified usage.
9. Failure to heed these markings may result in personal injury and/or property damage.

## **MAINTENANCE INSTRUCTIONS**

- Maintain your equipment. It is recommended that the general condition of any equipment be examined before it is used. Keep your equipment in good repair by adopting a program of conscientious repair and maintenance. Have necessary repairs made by qualified service personnel.
- Follow the maintenance instructions carefully to keep your equipment in good working condition. Never perform any maintenance on the equipment while it is under a load.
  - a. All moving parts of the equipment should be regularly cleaned.
  - b. Lubricate parts as required by the manufacturer's specifications. The type of lubricant should be as specified by the manufacturer or a qualified person. Lubrication systems should be checked to verify proper operation.
  - c. If additional maintenance is required, it should be completed in accordance with the instructions of the manufacturer or qualified person.

## **Binding**

If the product binds while under a load, use equipment with equal or a larger load capacity to lower the load safely to the ground. After un-binding; clean, lubricate and test that equipment is working properly. Rusty components, dirt, or worn parts can be causes of binding Clean and lubricate the equipment as indicated in the lubrication section. Test the equipment without a load. If the binding continues, contact Customer Service.

## **IF YOUR EQUIPMENT BINDS**

As your equipment becomes older, the threads may start binding. This will prevent the equipment from operating properly and safely. Rusty threads, dirty threads, or a worn threads can cause binding. Clean and lubricate the equipment. Test the equipment without a load. If the binding continues, refer to the after sale parts and service. If your equipment binds while under a load, use equipment with equal or larger load capacity to lower the load safely to the ground.

## **Cleaning**

If the moving parts of the equipment are obstructed, use cleaning solvent or another good degreaser to clean the equipment. Remove any existing rust, with a penetrating lubricant.

Do not use motor oil to lubricate the equipment

Rust Prevention:

- Check daily for any signs of rust or corrosion. Without a load check for signs of rust that are visible and clean as needed.

## **Storing the Equipment**

1. Store in a dry location, recommended indoors.
2. Equipment should be stored in an area where they will not be subjected to damage.
3. If extreme temperatures or chemically active or abrasive environments are involved, the guidance provided in shall be followed.
4. Temperature - When equipment are to be used at temperatures above

140°F (60°C) or below -20°F (-29°C), the

equipment manufacturer or a qualified person should be consulted.

5. Chemically Active Environments -The strength and operation of equipment can be affected by chemically active environments such as caustic or acid substances or fumes. The equipment manufacturer or a qualified person should be consulted before equipment are used in chemically active environments.

6. Other Environments - The internal workings of equipment can be affected by high moisture, gravel or sand, silt, grit, or other dust-laden air. Equipment subject to these environments should have their inner components frequently cleaned, inspected, and lubricated.

**Note:** If the equipment is stored outdoors, be sure to lubricate all parts before and after use to ensure the equipment stays in good working condition.

## ASSEMBLY INSTRUCTIONS

1. Attach caster assembly(21) to base assembly (20) with bolt (22), washer(23)spring washer (24) and nut (25). Attach caster assembly(28) to base assembly (20) with bolt (29), washer(23)spring washer (24) and nut (25). Attach caster assembly(21) to front leg(34) with bolt (22), washer(23)spring washer (24) and nut (25).
2. Insert front leg(34)to the base assembly(20). Lift one side of the front leg(34) to align the hole on front leg(34) to the hole on the for base assembly(20), then insert the lock pin (26) into the hole , and insert the R Pin (27) into the hole of lock pin.
3. Attach Support rod (18) to the base assembly (20) with bolt (30), washer (31), spring washer(32) and nut (33).
4. Attach pull plate(17) to the support rod (18)and base assembly (20) with bolt (2), washer (3), spring washer(4) and nut (5).
5. Attach jack(19) to Support rod (18) with bolt (2), washer(3)spring washer (4) and nut (5).
6. Attach main derrick(1) to Support rod (18) with bolt (42),washer(3)spring

washer (4) and nut (5).

7. Lift one side of the main derrick(1) to align the hole on the jack(19) to the hole on the for main derrick(1) , then insert the bolt (10) into the hole , and fasten it with washer (3), spring washer(4) , nut (5).
8. Insert telescopic rod(41) into proper position of the main derrick(1). Line up the hole in the main derrick(1) and the hole of telescopic rod(41), then insert the bolt (6) into the hole , and fasten it with washer (31), spring washer(32) , nut (33).
9. Attach chain hook (35) to the telescopic rod(42) with bolt (14), washer (15) and nut (16).
10. Attach two hanging jaw(39) to lock Pin(26),And fasten it to engine Leveler(36) with bolt(37).Repeat the above steps to fasten anther two hanging jaw(39) to engine Leveler(36).
11. Attach engine leveler assembly to the chain hook (35).
12. Tight all the screws.

## ASSEMBLY DIAGRAM

Item	Name	Qty.	Item	Name	Qty.
1	Main Derrick	1	22	Hex Head Bolt M8x15mm	16
2	Hex Head Bolt M16x100mm	4	23	Washer M8	24
3	Washer M16	6	24	Spring Washer M8	24
4	Spring Washer M16	6	25	Nut M16	24
5	Nut M16	6	26	Lock Pin	4
6	Hex Head Bolt M14x90mm	1	27	R Pin	20
7		/	28	Caster Assembly 3.0"	2
8		/	29	Cross Flat Head Bolt M8x20mm	8
9		/	30	Hex Head Bolt M14x100mm	2
10	Hex Head Bolt M16x75mm	1	31	Washer M14	3
11		/	32	Spring Washer M14	3
12		/	33	Nut M14	3
13		/	34	Front Leg	2
14	Hex Head Bolt M12x75mm	1	35	Chain Hook	1
15	Washer M12	1	36	Engine Leveler	1
16	Nut M12	1	37	Bolt M8x30	2
17	Pull Plate	2	38	Lock Ring	2
18	Support Rod	1	39	Hanging Jaw	4
19	Jack	1	40	Pressure Rod	1
20	Base Assembly	1	41	Telescopic Rod	1
21	Caster Assembly 3.3"	4	42	Hex Head Bolt M16x120mm	1



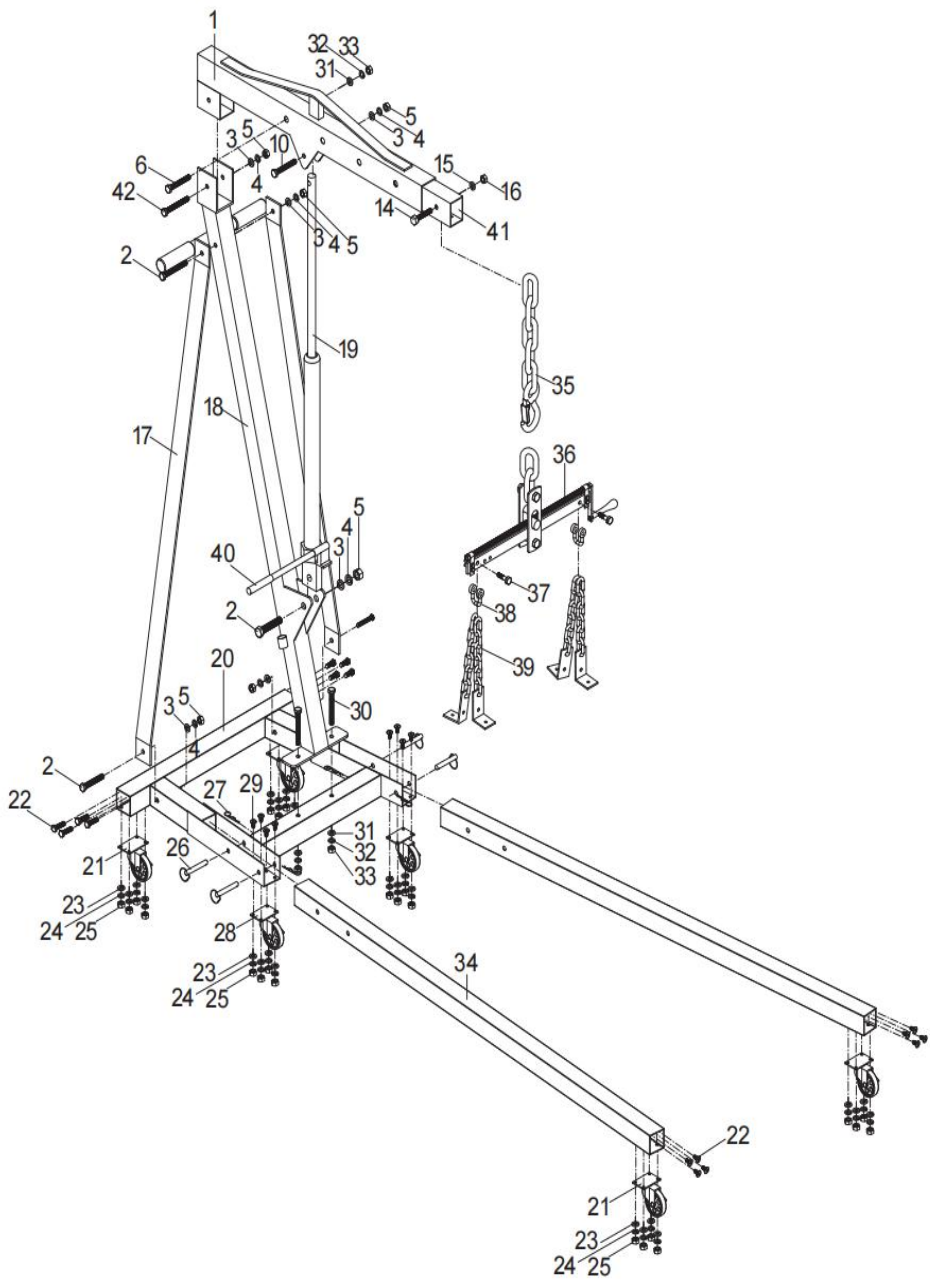

## FOLDING STORAGE

After use the equipment, you can fold the legs to save space. shown as the figure.

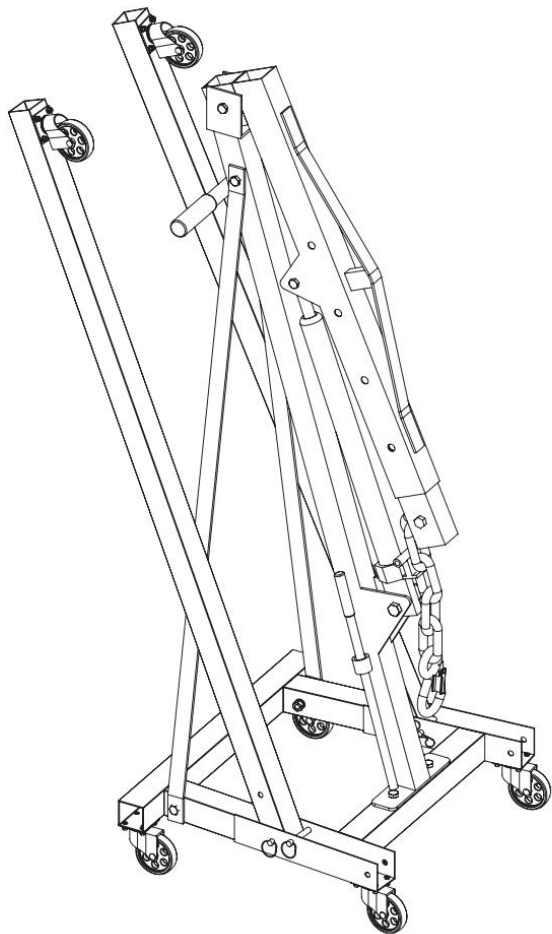

**Importer:** WAITCHX

**Address:** 250 bis boulevard Saint-Germain 75007 Paris

**Importer:** FREE MOOD LTD

**Address:** 2 Holywell Lane, London, England, EC2A 3ET



EUREP UK LTD

UNIT 2264, 100 OCK STREET, ABINGDON

OXFORDSHIRE ENGLAND OX14 5DH



EUREP GmbH

Unterlettenweg 1a, 85051

Ingolstadt, Germany

**Manufacturer:** Haiyan Xinxing Mechanical And Electrical. Co., Ltd

**Address:** Liuzhuang Village Xitang qiao Street Haiyan County Zhejiang Province

**Made In China**

**VEVOR<sup>®</sup>**

**TOUGH TOOLS, HALF PRICE**

**Technical Support and E-Warranty Certificate**

**[www.vevor.com/support](http://www.vevor.com/support)**

**Made In China**