

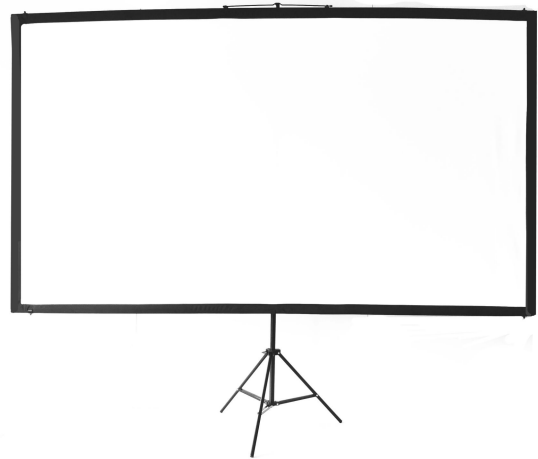





PORTABLE PROJECTOR SCREEN INSTRUCTION MANUAL



Warnings

- The warranty will only be valid if you follow the instructions below carefully! Improper use and care may cause serious injury and/or damage!
- Make sure the surface you have chosen for installing the screen is flat and secure.
- Please read the following as any damage to the screen surface will impact the image's quality:
 1. Do not touch the screen surface by hand.
 2. Do not write or draw on the screen surface.
 3. Do not poke the screen surface by finger or edge tools as it may cause scratches or tears.
- Retract the screen after every use.
- Do not pull two sides of the screen fabric by hands, do not fold the screen fabric.
- To prevent unnecessary damage, the operation and maintenance of the screen should be done by adult.

 <p>Ignoring the safety warnings may lead to injuries or damaging the product.</p>	 <p>The screen should be installed at secure place to avoid any accidents or the screen falling down.</p>
 <p>Retract the screen after every use. Leave it hanging for along period may cause screen fabric loose.</p>	 <p>Please contact your local dealer for repair or maintenance, and contact us if you have any further questions. Avoid taking apart the fixtures by yourself. Loose parts may cause the screen fall down.</p>
 <p>Avoid hanging anything on the screen as it may cause the screen to fall down.</p>	

Note:

Do not use any detergent or cleaning products to clean the screen surface, please clean it with a soft cloth and lukewarm water.

To the folding creases, please use garment steamer to make the screen smooth.

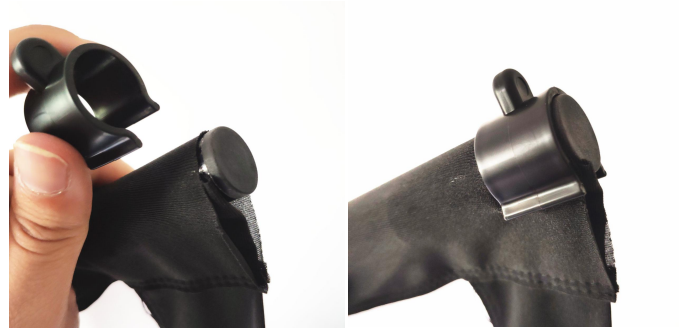
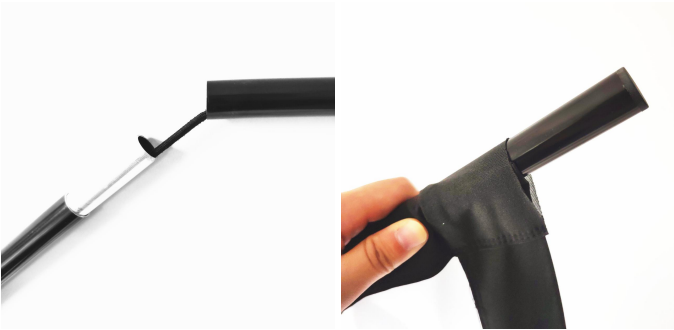
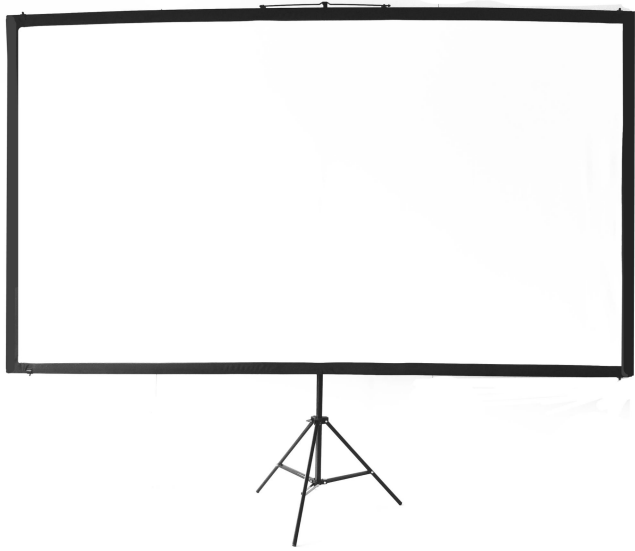

1 assemble the top and bottom horizontal poles and slide the poles through the fabric screen pole pocket

2 use the plastic U shape clips to fix the fabric screen with the top and bottom pole on the each end



3 fix the metal hanging part on the top pole, make sure it is in the middle position to keep balance, then hang on the top of the stand

4 adjust the stand height and use the connector to fix the bottom pole on the stand

Note: this product is suitable for dark environment for a better projection effect