

VEVOR[®]

TOUGH TOOLS, HALF PRICE

Technical Support and E-Warranty Certificate www.vevor.com/support

High Pressure Airless Sprayer USER MANUAL

We continue to be committed to provide you tools with competitive price.

"Save Half", "Half Price" or any other similar expressions used by us only represents an estimate of savings you might benefit from buying certain tools with us compared to the major top brands and does not necessarily mean to cover all categories of tools offered by us. You are kindly reminded to verify carefully when you are placing an order with us if you are actually saving half in comparison with the top major brands.

VEVOR[®]

TOUGH TOOLS, HALF PRICE

**HIGH PRESSURE
AIRLESS SPRAYER**



395

NEED HELP? CONTACT US!

Have product questions? Need technical support? Please feel free to contact us:

Technical Support and E-Warranty Certificate
www.vevor.com/support

This is the original instruction, please read all manual instructions carefully before operating. VEVOR reserves a clear interpretation of our user manual. The appearance of the product shall be subject to the product you received. Please forgive us that we won't inform you again if there are any technology or software updates on our product.

WARNING

The following is the setting of this equipment, use, grounding, maintenance and repair of general warnings related. In addition, in the present manual other suitable places there are even more explicit warnings. Signs appear throughout this manual refer to these general warnings. When the manual These symbols appear somewhere, go back to the following pages a description of the specific hazard.



Fire and explosion hazards

Solvent and paint fumes and other flammable fumes in work area can ignite or explode. To help prevent fire and explosion:

- In a well ventilated area using only this device.
- Eliminate all ignition sources such such as pilot lights, cigarettes, portable electric lamps and plastic drop cloths (potential static arc).



Spraying opportunity spark.

When the sprayer flammable liquids or flammable liquids or flammable liquids in the vicinity When the body is flushing or cleaning, keep sprayer at least 20 feet away from explosive vapors (6m).

- Keep work area free of solvent, debris, gasoline and other debris.
- Do not plug or unplug power cords or turn lights when flammable fumes are present.
- The work area equipment and conductive objects. Read Grounding instructions.
- If there is static sparking or you feel a shock, stop operation immediately. Until you identify and correct the problem, do not using the device.
- Keep a fire extinguisher in the work area.



Shock hazard

Improper grounding system is provided incorrect or improper use can cause

electric shock.

Before servicing equipment, turn off the power and disconnect the power cord.

- Use only grounded electrical outlets.
- Use only three-core extension cords.

Ensure ground sprayer and extension cords prongs are intact.

- Do not expose to rain. To be stored indoors.



SKIN INJECTION HAZARD

From the gun, hose leaks, or ruptured components emitted by the high-pressure fluid can pierce the skin. Injuries look like "just

A cut mouth," it is a serious injury that can result in amputation. Get immediate surgical treatment.

- Do not point the gun at anyone or any part of the body.
- Do not put your hand over the nozzle.
- Do not hand, body, glove or rag stop or deflect leaks.
- Engage trigger lock when not spraying.
- When you stop spraying and before cleaning, checking, or servicing equipment, follow the Pressure Relief Procedure in this manual.



SKIN INJECTION HAZARD

From the gun, hose leaks, or ruptured components emitted by the high-pressure fluid can pierce the skin. Injuries look like "just A cut mouth," it is a serious injury that can result in amputation. Get immediate surgical treatment.

- Do not point the gun at anyone or any part of the body.
- Do not put your hand over the nozzle.
- Do not hand, body, glove or rag stop or deflect leaks.
- Engage trigger lock when not spraying.
- When you stop spraying and before cleaning, checking, or servicing equipment, follow the Pressure Relief Procedure in this manual



Dangerous high -voltage aluminum parts

Do not use 1,1,1-trichloroethane, methylene chloride in pressurized aluminum equipment, and other hydrogenated hydrocarbon solvents or contain Fluid these solvents. Doing so can cause serious chemical reaction and equipment rupture, and result in serious personal injury or death And property damage.



Fluid or smoke poisoning hazard

“If the inhalation of toxic fumes, ingestion of toxic fluid or splashed in the eyes or on the skin can cause serious injury or death.

- Read Material Safety Data Sheet (MSDS), familiar with the specific hazards of the fluids.
- Hazardous fluid stored in approved containers, and dispose of in accordance with the requirements of the relevant provisions.



Personal Protective Equipment

When operating or servicing equipment, or when in the operating area of the equipment, and must wear appropriate protective equipment to protect against Serious injuries (including eye injury), inhalation of toxic fumes, burns, and hearing loss. These items include, but are not Limited to:

- .Goggles
- . Fluid and solvent manufacturer recommended protective clothing and a respirator
- Gloves
- . Hearing protection

Prior to using this product, please read and understand all instructions and safety warnings. Improper use may result in serious injury or property damage.

1. Warnings must be followed carefully to avoid body injury. Improper use may result in electric shock, fire, personal injury and other damage:

- 1) Keep unplugging when moving the machine.
- 2) Keep unplugging when installing accessories
- 3) Place on a flat and stable platform and operate under ventilated conditions
- 4) Wear special protective equipment when operating the machine
- 5) Do not use this machine in a hazardous-location.

- 6) Do not use when the machine is not working properly.
- 7) Do not disassemble and repair this machine.
- 8) Do not use an unsuitable AC Outlet.
- 9) Do not touch the heating plate when the machine is heating .
- 10) Do not use in a humid environment or contact with water. Do not infiltrate liquid in the machine to prevent fire or electric shock caused by short circuit.
- 11) Do not use the power supply that does not meet the rated voltage. The power supply that does not meet the specified voltage may cause fire or electric shock.
- 12) Ensure that the machine is grounded so as not to cause harm to the body.
- 13) Do not touch the rotating rod or bearing part with your fingers during use in case of injuries.
- 14) If the machine is not in use for a long time, please unplug the power cord from the socket.
- 15) Do not use the machine during thunderstorms or lightning to avoid damage to the machine.
- 16) Place the machine smoothly on the flame-retardant table and keep away from flammable and explosive items.
- 17) Please stop using it if the machine smokes, emits a peculiar smell, or becomes noisy and in other abnormal conditions.
- 18) This appliance can be used by children aged from 8 years and above and persons with reduced physical , sensory or mental capabilities or lack of experience and knowledge
if they have been given supervision or instruction concerning use of the appliance in a safe way and understand the hazards involved. Children shall not play with the appliance. Cleaning and user maintenance shall not be made by children without supervision
- 19) Type Z attachment: If the supply cord cannot be replaced. If the cord is damaged the appliance should be scrapped.
- 20) In order to avoid a hazard due to inadvertent resetting of the thermal cutout, this appliance must not be supplied through an external switching device, such as a timer, or connected to a circuit that is regularly switched on and off by the utility.

FCC INFORMATION

CAUTION: Changes or modifications not expressly approved by the party responsible for compliance could void the user's authority to operate the equipment!

This device complies with Part 15 of the FCC Rules. Operation is subject to the following two conditions:

- 1) This product may cause harmful interference.
- 2) This product must accept any interference received, including interference that may cause undesired operation.

WARNING: Changes or modifications to this product not expressly approved by the party responsible for compliance could void the user's authority to operate the product.

Note: This product has been tested and found to comply with the limits for a Class B digital device pursuant to Part 15 of the FCC Rules, These limits are designed to provide reasonable protection against harmful interference in a residential installation.

This product generates, uses and can radiate radio frequency energy, and if not installed and used in accordance with the instructions, may cause harmful interference to radio communications. However, there is no guarantee that interference will not occur in a particular installation. If this product does cause harmful interference to radio or television reception, which can be determined by turning the product off and on, the user is encouraged to try to correct the interference by one or more of the following measures.

- Reorient or relocate the receiving antenna.
- Increase the distance between the product and receiver.
- Connect the product to an outlet on a circuit different from that to which the receiver is connected.
- Consult the dealer or an experienced radio/TV technician for assistance.

SPECIFICATIONS

Item	Description	395	395
1	Rated Voltage	120VAC 60Hz(For US)	120VAC 60Hz(For US)
2	Rated Voltage	230VAC 50Hz(For Europe)	230VAC 50Hz(For Europe)
3	Rated Power	2200W	2000W
4	Maximum Working Pressure (MWP)	3000 PSI	3000 PSI
5	Maximum Delivery	2.0 LPM	2.0 LFM
6	Work Environment Temperature	5°C-40°C/40°F-105°F	5°C-40°C/40°F-105°F
7	Standard Nozzle	621	621
8	Transportation and Storage Temperature	-25°C-55°C/-13°F-131°F	-25°C-55°C/-13°F-131°F
9	Hose Length	9m /29.5ft	9m /29.5ft

SETTING STEP

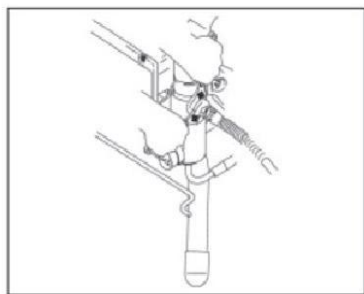

1. there will be no gas hose to the sprayer, Tighten securely.

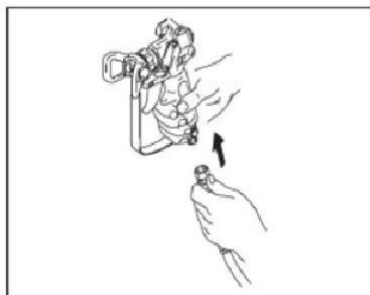

2. the other end of the hose to the gun.

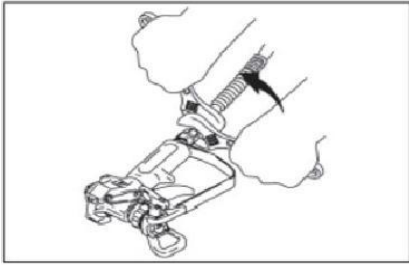

3.Tighten

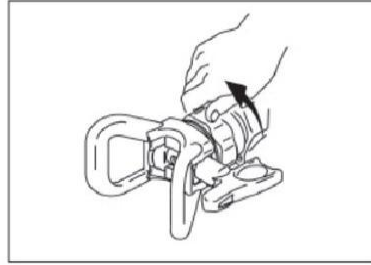

4.Remove tip guard

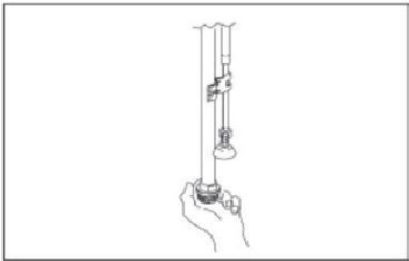

5.Check inlet strainer for obstructions and dirt

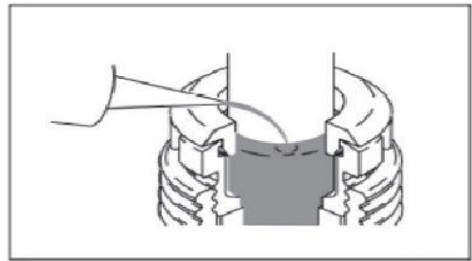

6.To the throat packing nuts with throat seal liquid to prevent premature seal wear.have to do every time you spray.

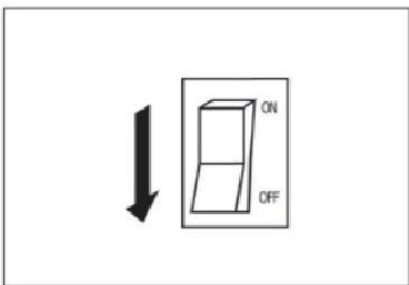

7.Turn off the power

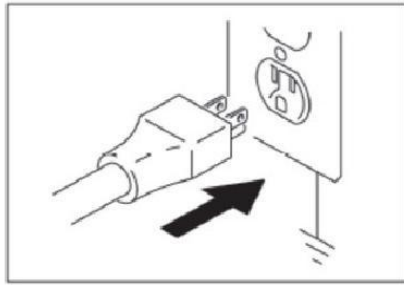

8.Plug the power cord into a properly grounded electrical outlet.



9. The filler valve downward rotation.

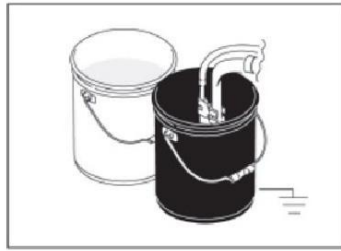

10. The siphon tube set into the inner fluid filled with grounded metal pail. Pull to the wire with the bucket connected to a true earth ground. The oil is stored in sprayer washed away. Rinse water-based paint, oil paint and storage oil rinse with mineral spirits.

Nozzle and shroud

1. Insert the crescent-shaped gasket into the circular hole of the nozzle seat, making sure that the metal arc of the crescent-shaped gasket completely overlaps with the metal arc inside the circular hole of the nozzle seat.

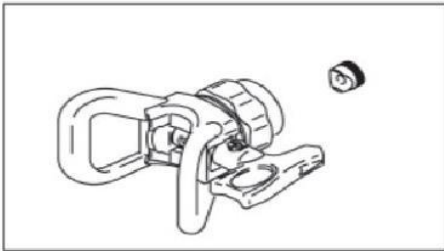

2. Insert the nozzle into the circular hole of the nozzle seat, making sure that the nozzle is inserted all the way in and that one end of the plastic handle tip of the nozzle is facing directly forward.

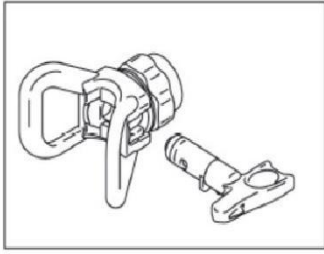

3. Use a wrench to tighten the nozzle seat assembly and the extension rod or spray gun.

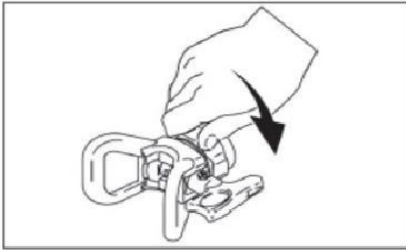

CLEAR BLOCKAGE

1.
 - a) the release of the trigger, put safety.
 - b) the spinning nozzle.
 - c) Open the safety pin.
 - d.) Trigger gun to clear the clog.
- Never point gun at your hand or a rag!

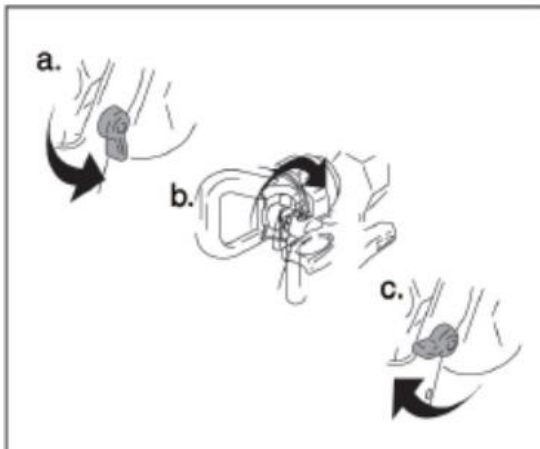

2.

a) lock safety pin.

b) is rotated to the original position.c.) to open the safety pin, and then continue spraying.

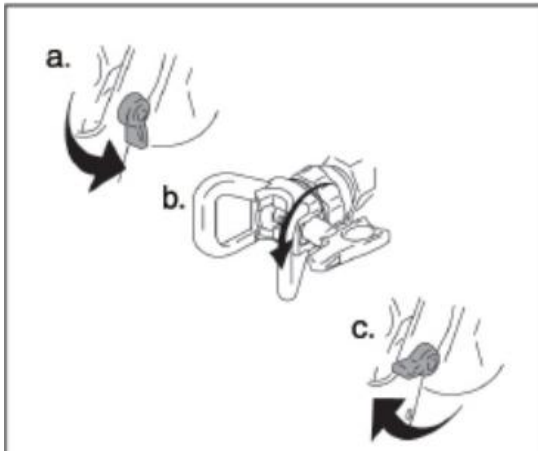

CLEARING

1. Turn off the power and unplug the power cord sprayer.

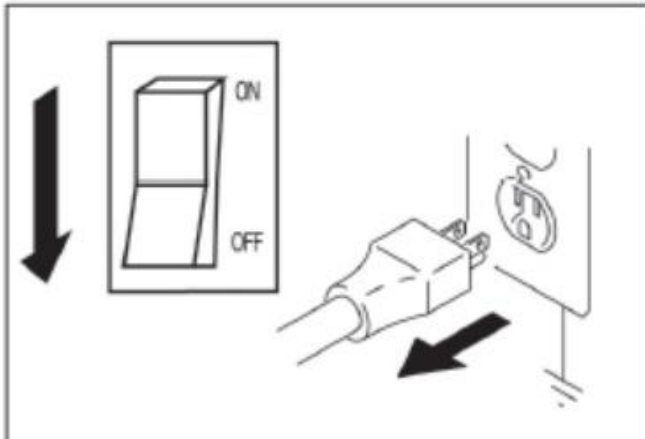

2.The pressure to lowest setting Trigger spray seizure trigger to relieve pressure.

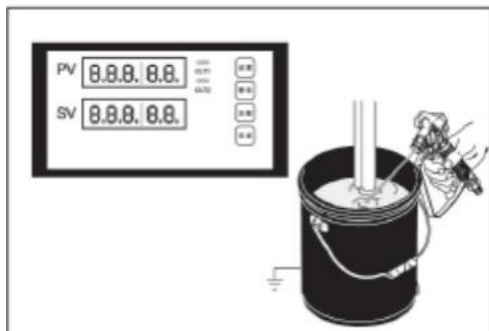

3.Drain hose into the bucket. The filler valve downward rotation.



4.Remove the cover and nozzle

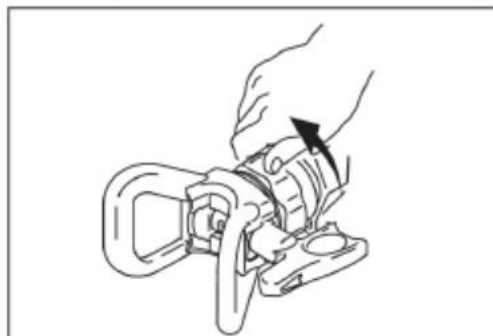

5.The siphon tube set from paint and place in flushing fluid.Water and water-based paint,oil paint with mineral spirits.



6.Plug sprayer power cord. Power.The filler valve rotated to a horizontal position.

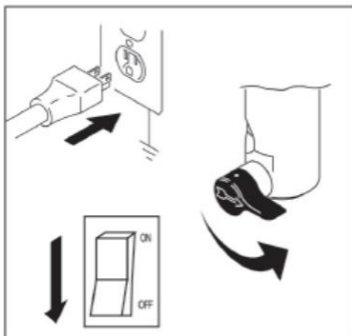

7.Hold gun against paint pail.Trigger safety pin. Trigger gun and increase pressure until flushing fluid.

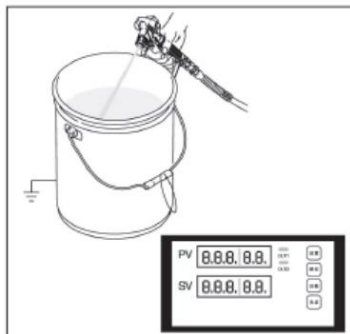

8. Move gun to flushing pal, hold gun against pail, trigger gun to thoroughly flush system. Release trigger and lock trigger safety.



9. The filler valve is rotated downward and then let flushing fluid to circulate 1-2 minutes to clean drain tube.

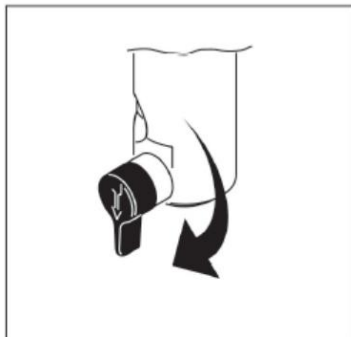

10. The suction pipe raised above flushing fluid and run sprayer for 15 to 30 seconds to drain fluid. Turn off the power.



11. Close relief valve. Flushing pail gun trigger to discharge fluid hose.



12. Open filler valve

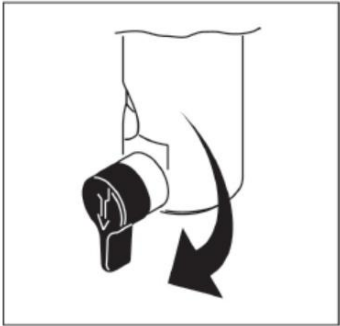

13. If equipped with a filter on the gun and sprayer, then remove them. Clean and inspect.

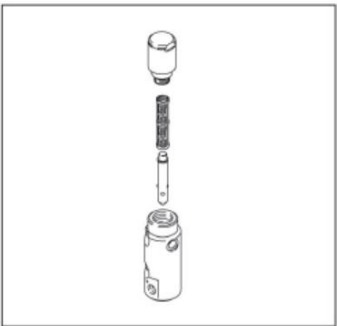

14.If it is washed with water, re-wash again with mineral spirits to leave a protective coating to prevent freezing or corrosion.

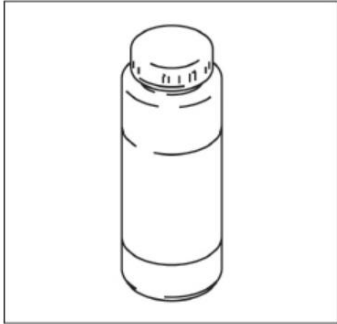

15.With a soak in water or mineral spirits rags Wipe sprayer, hose and gun.



Trouble Shooting

problem	The reason	Solve
A.Sprayer not start	<ol style="list-style-type: none"> 1. The sprayer is not powered 2. Brush has come to life 3. When the case is still in with a pressure sprayer is switched off. 5 The extension cord is damaged or the power is too low 6. Spray the cabinet flow 	<ol style="list-style-type: none"> 1.Power 2.Replace brushes 3. The pressure is adjusted to the highest position or return valve rotation to the return site 4. Test the power supply voltage, to ensure a stable voltage. 5.Replace the drag strip

	<p>protection operation</p> <p>7. The motor has a problem</p>	<p>6. Please reset the protector after troubleshooting</p> <p>7. Take the device to the agency maintenance</p>
<p>B. Spray function starts, when the switch is set to reflux can not blow down</p>	<p>1. Unable to reflux</p> <p>2. The paint bucket is empty or the suction tube Not completely immersed in the paint</p> <p>3. The suction tube blockage The suction tube and suction valve junction unsealed</p> <p>5. The inlet valve or outlet valve stuck</p> <p>6. The intake valve wear or damage</p> <p>7. return valve blockage</p>	<p>1. Try to look again at reflux.</p> <p>2. Load the paint bucket or suction tube is fully immersed in the paint</p> <p>3. Clean the suction tube</p> <p>4. Clean the pipe connections, and the solid</p> <p>5. Clean the inlet, outlet valve or replace worn parts</p> <p>6. Replace the intake valve</p> <p>7. Take the device to the agency maintenance.</p>
<p>C. The rapid decline in spraying lance opening pressure</p>	<p>1. nozzle wear serious</p> <p>2. Suction filter clogging</p> <p>3. Paint or paint too viscous The discharge valve is not clean or wear</p> <p>4. The intake valve is damaged or worm</p>	<p>1. Replace the nozzle</p> <p>2. Clean intake filter</p> <p>3. The diluted paint or coating</p> <p>4. Clean or replace the outlet valve</p> <p>5. Replace the intake valve</p>
<p>D. When the switch is refluxed for spraying liquid from the return conduit flows.</p>	<p>1. Reflux valve is not clean or wear</p>	<p>1. Take the device to the agent for repair or renewal return valve</p>
<p>E. Spray leak</p>	<p>1. Gun internal parts are not clean or wear</p>	<p>1. Take the device to the agency maintenance</p>
<p>F. Nozzle seat leakage</p>	<p>1. nozzle seat improper assembly parts</p> <p>2. The seal wear</p>	<p>1. Check the nozzle seat is fitted</p> <p>2. Replace the seals</p>

<p>G.Absolutely can not stand the pressure spray or Normal force shot instantaneous pressure reduction Small enough traffic</p>	<p>1.nozzle or filter is clogged 2. The cleaning nozzle in reverse position 3.clogged suction port</p>	<p>1.Clean the nozzles or cartridge 2.Place the nozzle in spray position 3.Clean dirty dirt</p>
<p>H.Paint unevenly distributed</p>	<p>1.Set the spray pressure is too low 2. guns, nozzles, filters blocked 3. The suction tube and suction valve junction unsealed 4.nozzle wear 5. The paint is too thick 6.Pressure leak</p>	<p>1.Increase spray pressure 2.Clean the filter 3.Strengthening the suction tube 4. Replace the nozzle 5.diluted paint or coating 6.View Solution C</p>
<p>I.Sprayer lack of motivation,low pressure</p>	<p>1.The pressure is set too low 2. The power supply voltage is low</p>	<p>1.Adjust the pressure control knob clockwise to increase pressure setting. 2.Select high-quality power access port work</p>

Address: Baoshanqu Shuangchenglu 803long 11hao 1602A-1609shi Shanghai
Imported to AUS: SIHAO PTY LTD. 1 ROKEVA STREETEASTWOOD NSW 2122 Australia

Imported to USA: Sanven Technology Ltd. Suite 250, 9166 Anaheim Place, Rancho Cucamonga, CA 91730



SHUNSHUN GmbH
 Römeräcker 9 Z2021,76351
 Linkenheim-Hochstetten, Germany
 Tel: +49 1727041930 euvertreter@gmail.com



Pooledas Group Ltd
 Unit 5 Albert Edward House, The
 Pavilions Preston, United Kingdom
 Tel: 01772418127 pooledas123@gmail.com

Made In China

VEVOR[®]

TOUGH TOOLS, HALF PRICE

Technical Support and E-Warranty Certificate

www.vevor.com/support