

VEVOR[®]

TOUGH TOOLS, HALF PRICE

Technical Support and E-Warranty Certificate

www.vevor.com/support

OUTDOOR STORAGE BOX

USER MANUAL

We continue to be committed to provide you tools with competitive price. "Save Half", "Half Price" or any other similar expressions used by us only represents an estimate of savings you might benefit from buying certain tools with us compared to the major top brands and does not necessarily mean to cover all categories of tools offered by us. You are kindly reminded to verify carefully when you are placing an order with us if you are actually saving half in comparison with the top major brands.

VEVOR[®]

Outdoor Storage Box

MODEL:SKC053A



NEED HELP? CONTACT US!

Have product questions? Need technical support? Please feel free to contact us:



CustomerService@vevor.com

This is the original instruction, please read all manual instructions carefully before operating. VEVOR reserves a clear interpretation of our user manual. The appearance of the product shall be subject to the product you received. Please forgive us that we won't inform you again if there are any technology or software updates on our product.

IMPORTANT CAUTIONS

!Please read the following instructions carefully before starting the installation:

1. Once installed, the product cannot be separated. Please strictly follow the steps in the manual for installation.
2. Before installation, please check whether all parts are intact or sufficient.
3. Some parts contain sharp burrs. Please wear gloves for installation if necessary.
4. When installing with electric tools, please adjust the torque to the minimum to avoid damaging the parts.

SAFETY INSTRUCTIONS

1. Check all panels/bolts for tightness before use.
2. Assemble all components according to the instructions. Please do not skip any steps!
3. When using electric tools, wear goggles and always follow the manufacturer's instructions.
4. Do not store anything that is very hot, such as a recently used grill, blowtorch, etc.
5. Do not stand on the lid.
6. Do not allow children to play inside the box to prevent the risk of suffocation.
7. Do not store flammable or corrosive substances.

MODEL AND PARAMETERS

Model	SKC053A
Maximum Capacity	31 Gallons
Weight Capacity	170 lbs
Product Size	L22.09xW17.1xH20.86inch
Materials	PP
Color	Grey

ASSEMBLY

1. To facilitate identification and installation, all parts are marked as shown in the figure below.
2. The installation requires force.

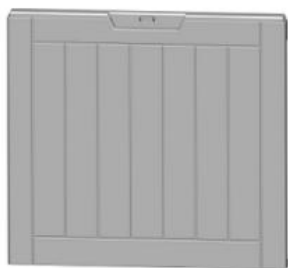

Front Panel **A** (x1)

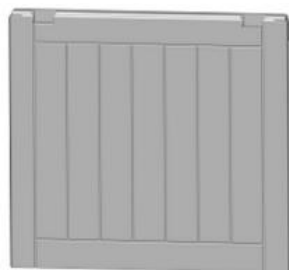

Back Panel **B** (x1)



Side Panel **C** (x2)

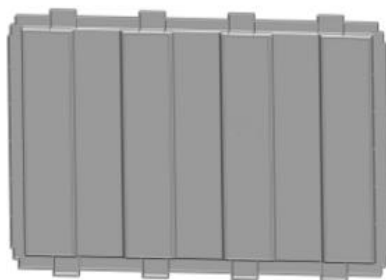

Bottom Panel **D** (x1)



Top Panel **E** (x1)

Step1:

Align the corresponding edge and slot as shown in the figure below.

Insert both sides of the D panel into the card slot in the C panel.

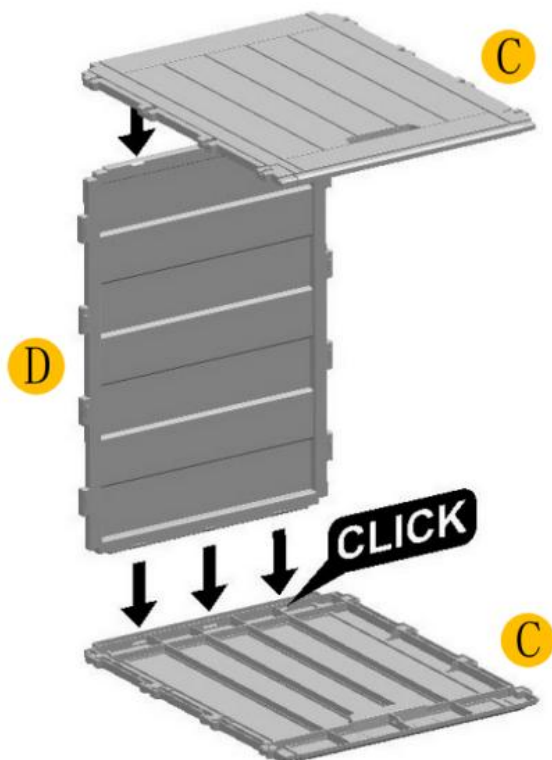

Step2: Attach back panel B.

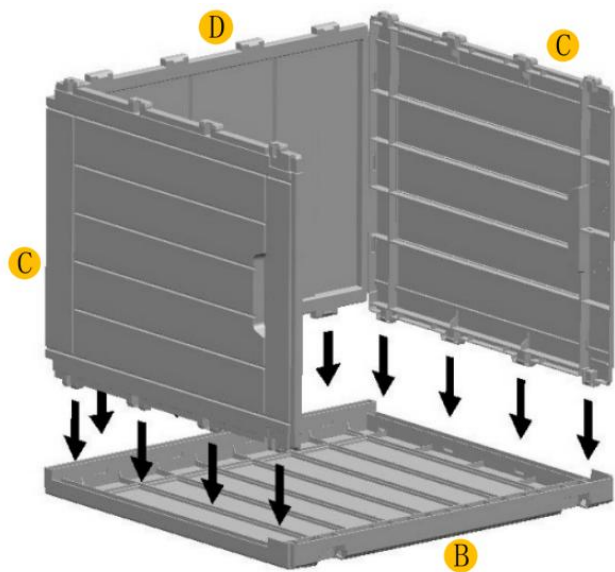

Step3: Install the front panel A.

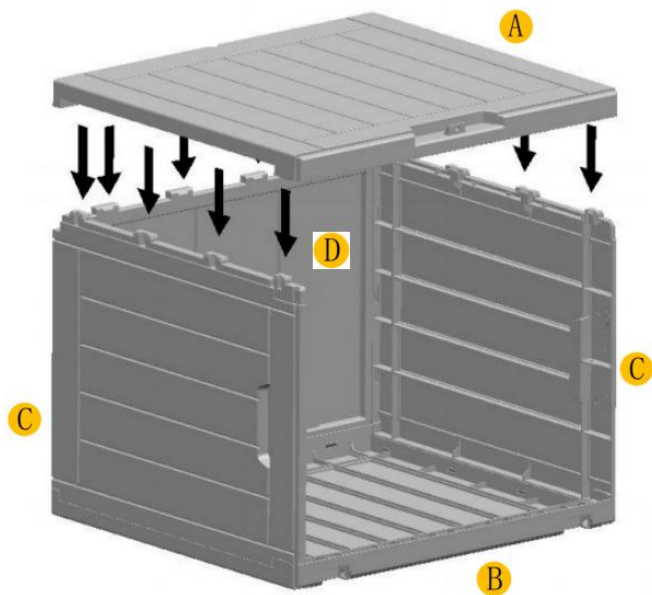

Step4: Install the top panel E (Top).

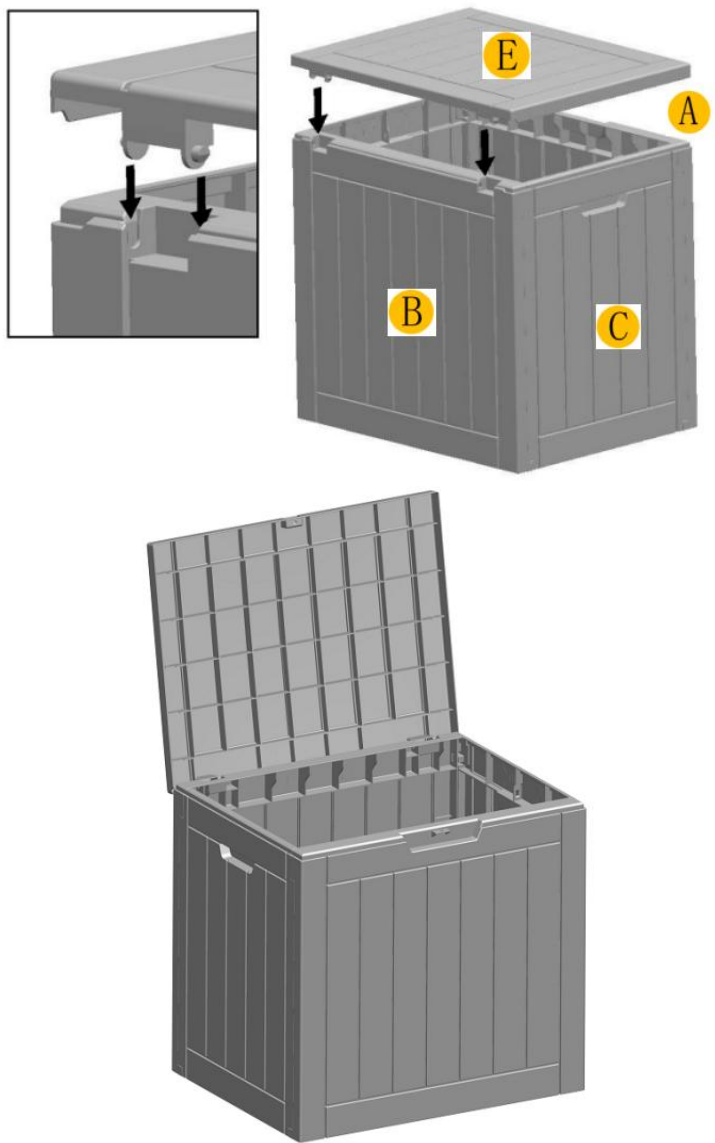

Step5: Installation completed.

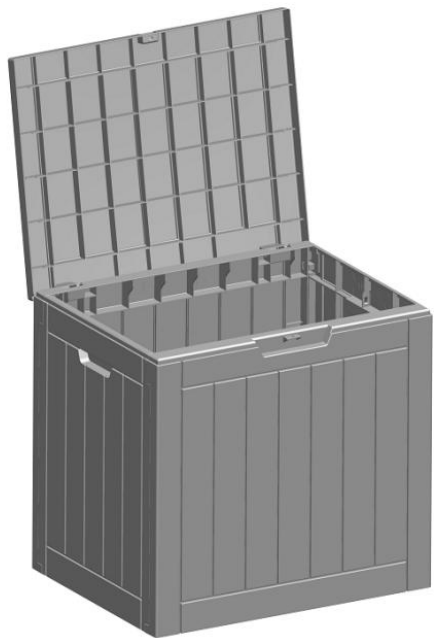

INSTRUCTIONS FOR PARTS

1. **Aluminum nameplate:** You can bring your own 4-ST3.5x10 screws/double-sided tape to hold the aluminum plate in place.



2. Box lock: The lock is opened at the original number 0-0-0, aligned with the indication line.(Even though dials may be positioned at different numbers.)

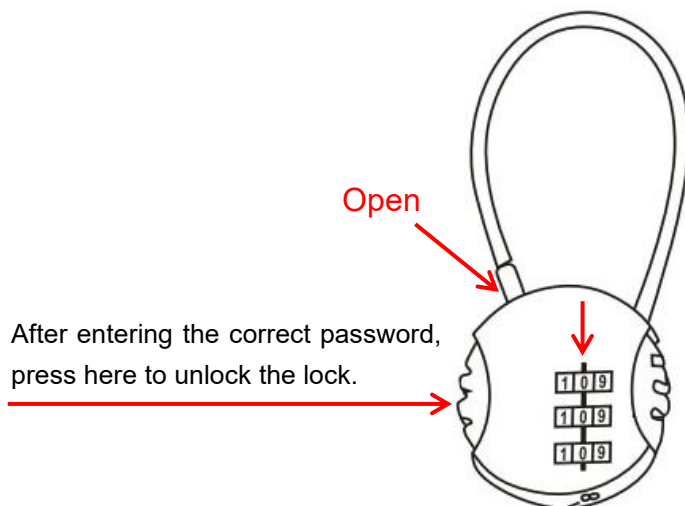

To set your personal combination, follow these steps:

1. Use a shape tool (such as a pencil) to insert and hold against A below. (Until password setting is complete)



2. Turn the dials to set your personal combination.



3. Release the shape tool. Now your new personal combination is set.
4. Remember well your new combination. If you want to change it again, please repeat.

CLEAN AND CARE RULES

1. Do not use a stiff brush or abrasive cleaner to avoid damaging the box.
2. After the rain, please wipe the box with a cloth before opening it.

VEVOR STORE INC

9448 RINCHMOND PL #E RANCHO CUCAMONGA, California, 91730

United States of America

VEVOR[®]

TOUGH TOOLS, HALF PRICE

Technical Support and E-Warranty Certificate

www.vevor.com/support