

VEVOR[®]

TOUGH TOOLS, HALF PRICE

Technical Support and E-Warranty Certificate www.vevor.com/support

HOUSEHOLD MACHINERY MOVER USER MANUAL

Model:JYD-114, JYS-135, JYF-114, JYF-250,JYF-450

We continue to be committed to provide you tools with competitive price.

"Save Half", "Half Price" or any other similar expressions used by us only represents an estimate of savings you might benefit from buying certain tools with us compared to the major top brands and does not necessarily mean to cover all categories of tools offered by us. You are kindly reminded to verify carefully when you are placing an order with us if you are actually saving half in comparison with the top major brands.

VEVOR®

HOUSEHOLD MACHINERY MOVER



NEED HELP? CONTACT US!

Have product questions? Need technical support? Please feel free to contact us:

 CustomerService@vevor.com

This is the original instruction, please read all manual instructions carefully before operating. VEVOR reserves a clear interpretation of our user manual. The appearance of the product shall be subject to the product you received. Please forgive us that we won't inform you again if there are any technology or software updates on our product.

WARNING

1. Read carefully and understand all **ASSEMBLY AND OPERATION INSTRUCTIONS** before operating.
2. Failure to follow the safety rules and other basic safety precautions may result in serious personal injury.

GENERAL SAFETY RULES

1. It is recommended to use this product on flat, hard ground.
2. It is strictly prohibited to use this product on uneven or soft ground, which is liable to cause property and personal injury.
3. 3.This product is not suitable for use on sloping ground, otherwise accidents will occur easily.
4. 4.Do not use more than the product load capacity.
5. 5.Because the ground is not smooth, the wheels of each mover may not be all involved in the work, it is recommended under the nominal load to use.
6. 6.When using this product, it should be moved slowly at a low speed, as excessive speed can easily cause the mover to slide out, Accidents happen easily.
7. 7.When the load is lighter, the steering performance of the mover is about good; conversely, the steering performance of the mover is not good.Do not swerve when the operator is struggling to turn. it is recommended to use crowbar lifting to assist the mover steering.
8. 8.In the use of this product, avoid collision, otherwise the product can not be used due to damage
9. 9.Do not recommend the use of a single or 2 movers together to carry large Furniture, such use is not safe;For heavy Furniture, 3 or 4 movers are usually used together.
- 10.10.For high and narrow Furniture, due to the high center of gravity, the use of mover handling measures to prevent possible overturning.
- 11.11.When multiple movers are used together, non-slip mats are added

to ensure consistency in height;When handling, control the direction of each mover should be consistent, otherwise it is difficult or impossible to move.When turning, it is suggested to lift the weight slightly with the aid of crowbar and other tools to facilitate the mover to turn.

SAVE THESE INSTRUCTIONS

MODEL AND PARAMETERS

Model	JYD-114	JYS-135	JYF-114	JYF-250	JYF-450
Total Load Capacity	250lbs	250lbs	250lbs	500lbs	1000lbs
Package	4pcs	4pcs	4pcs	4pcs	4pcs
Number of Wheels	Four Directional Wheels	Three Universal Wheels	Four Universal Wheels	Four Universal Wheels	Five Universal Wheels
Wheel Type	PP	PP	PP	PP	PP
Material	Plastic	Carbon Steel	Carbon Steel	Carbon Steel	Carbon Steel
Color	Red	Silver Gray	Silver Gray	Silver Gray	Black

STRUCTURE DIAGRAM

JYD-114

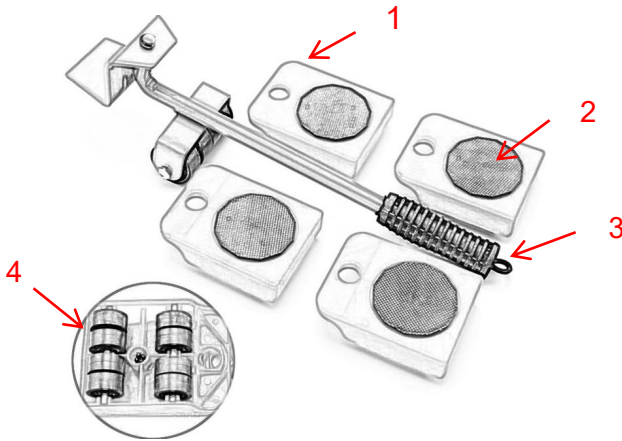

1. Household Machinery Mover 2.Non-slip Mat 3.Crowbar
4 .Directional Wheels

JYS-135

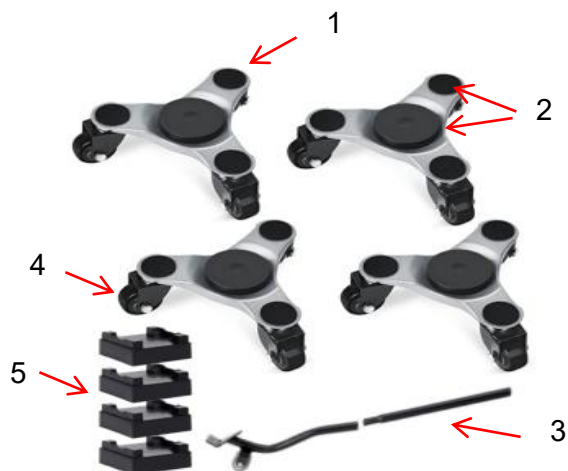

1. Household Machinery Mover 2.Non-slip Mat 3.Crowbar
4 .Universal Wheel 5. Heightening Pad

JYF-114, JYF-250, JYF-450

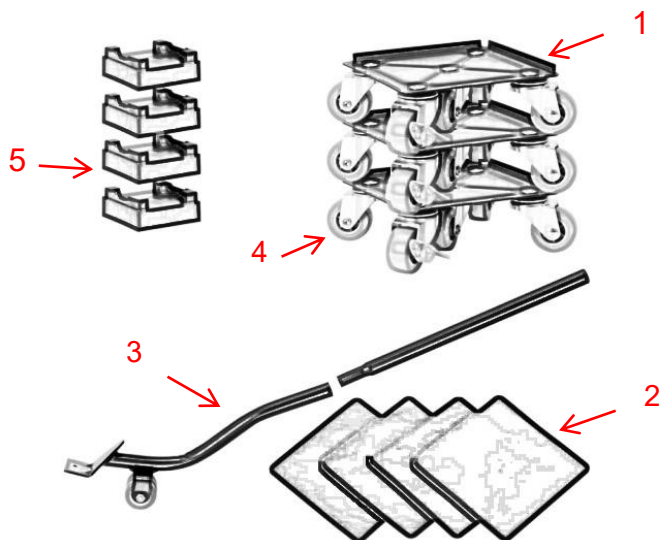

1. Household Machinery Mover 2.Non-slip Mat 3.Crowbar
4 .Universal Wheel 5. Heightening Pad

COMPONENTS

NO.	Name	JYD-114	JYS-135	JYF-114	JYF-250	JYF-450
1	Household Machinery Mover	4	4	4	4	4
2	Crowbar	1	1	1	1	1
3	Heightening Pad	4	4	4	4	4
4	Non-slip Mat	/	4	4	4	4
5	User manual	1	1	1	1	1

OPERATING INSTRUCTION

Step1: Push the crowbar into the bottom of the furniture ,hold the handle and press down.

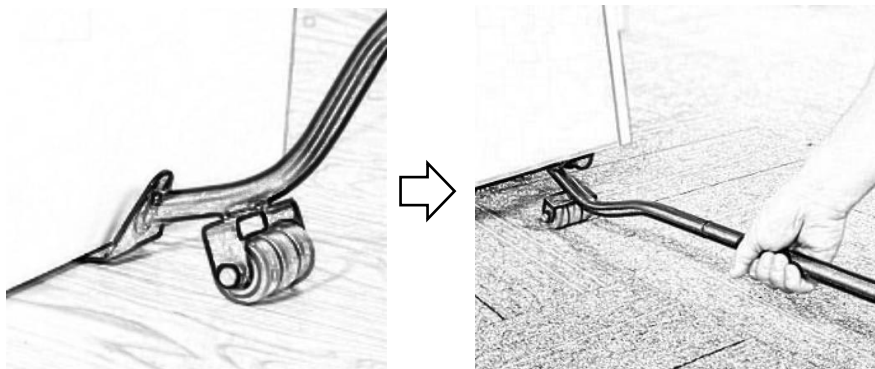

NOTE: The crowbar is equipped with heightening pads to fit furniture of different heights.

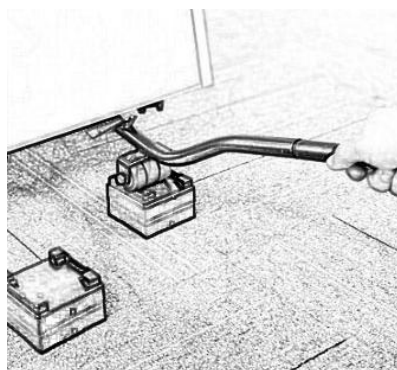

Step2: Push household machinery movers into the bottom of the furniture, pull out the crowbar.

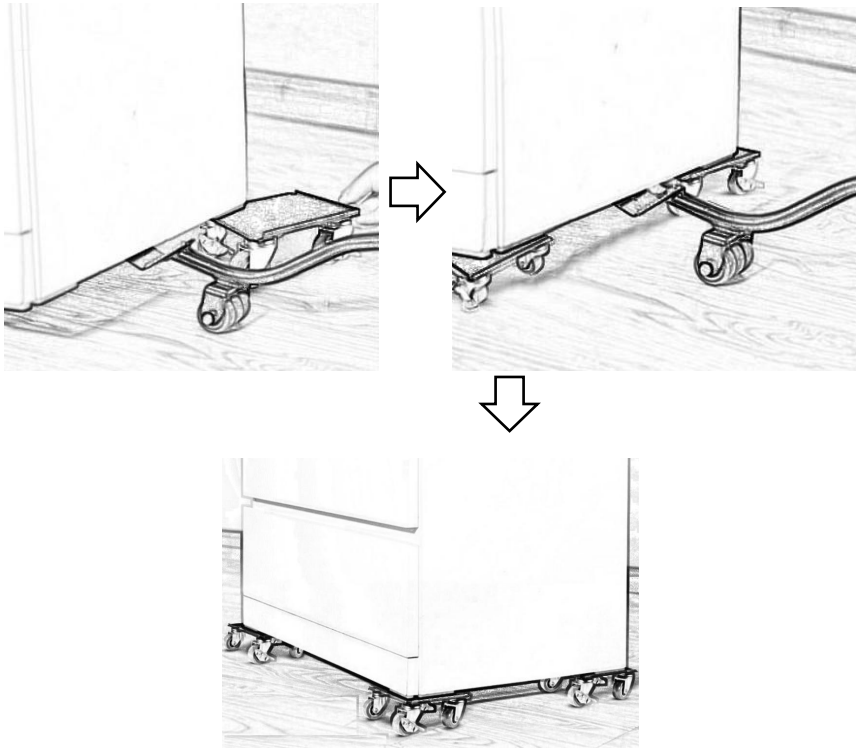

Step3: Push 4 household machinery movers into the bottom four corners of the furniture.

Make sure the installation is secure and you can move the furniture.

NOTE:

- 1) This product is suitable for moving furniture indoor on flat floor, not be used on uneven,soft ground,such as cement,similar cement,carpets and so on.
- 2) This product is not suitable for sloping ground or ground with steps.
- 3) For furniture with legs, Make sure the legs of the furniture are centered on the mover. The correct usage is shown below Fig 1 , Fig2

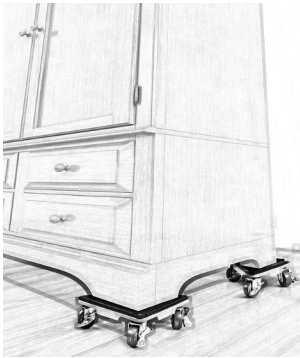

Fig 1



Fig 2

4) For bottom flat furniture, Make sure the top side of the tool is placed completely on the bottom of the furniture, as shown below Fig 3 ,Fig4

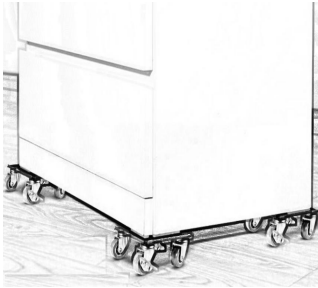

Fig 3



Fig 4(JYS-135)

5) When using this product, it should be moved slowly at a low speed, as excessive speed can easily cause the mover to slide out.

6) A mover equipped with universal wheels has good steering performance and requires slow rotation when turning.

7) A mover(JYD-114) equipped with directional wheels requires manual assistance when turning.

8) A mover equipped with brakes that can be used when needed to prevent the mover from moving.

MAINTENANCE

1. After the mover is used, please clean it first and keep it in a dry environment.
2. Regular inspection of the mover, Replace the wheel or mover in time, if the wheel is damaged.
3. After use, PP Wheel's mover should be cleaned in time, because the wheel is easy to be hurt by sharp objects such as iron filings, sand, oil, etc.

Address: Baoshanqu Shuangchenglu 803long 11hao 1602A-1609shi
Shanghai

Imported to AUS: SIHAO PTY LTD, 1 ROKEVA STREETEASTWOOD
NSW 2122 Australia

Imported to USA: Sanven Technology Ltd., Suite 250, 9166 Anaheim
Place, Rancho Cucamonga, CA 91730



Pooledas Group Ltd
Unit 5 Albert Edward House, The Pavilions
Preston, United Kingdom



SHUNSHUN GmbH
Römeräcker 9 Z2021, 76351
Linkenheim-Hochstetten, Germany

Made In China



TechnicalSupport and E-Warranty Certificate
www.vevor.com/support